

Cooling capacity(water outlet temp. 7℃)	Cooling capacity(water outlet temp. 10℃)	Cooling capacity(water outlet temp. 15℃)	Total power(middle/high pressure)	Cooling water inlet(inch)	Cooling water outlet(inch)	Chilled water inlet(inch)	Chilled water outlet(inch)	Drainage outlet(inch)	Water tank refill port(inch)	Cooling water flow(L/min)	Flow rate of chilled water(L/min)	Water tank capacity(L)	Weight(kg)	Ver.
14kw	15kw	17kw	3.93/4.28kw	Rc1.5	Rc1.5	Rc1	Rc1	Rc1/2	Rc1/2	60.9	48.7	80	250	C

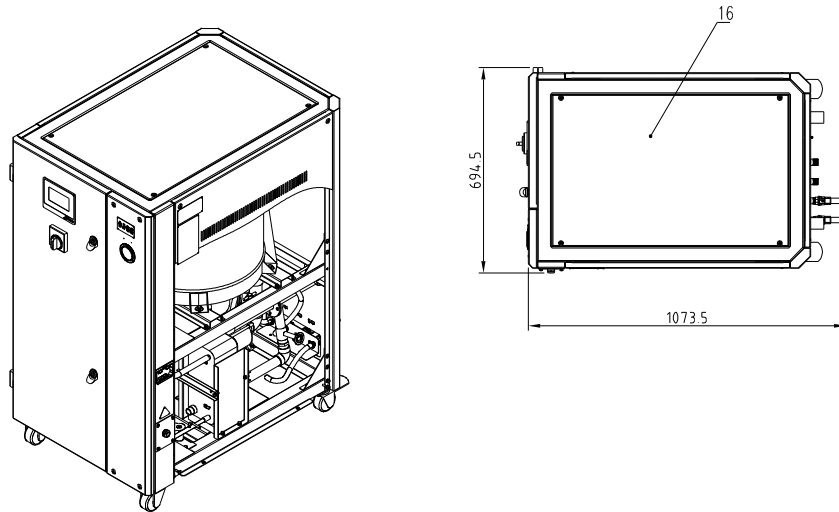
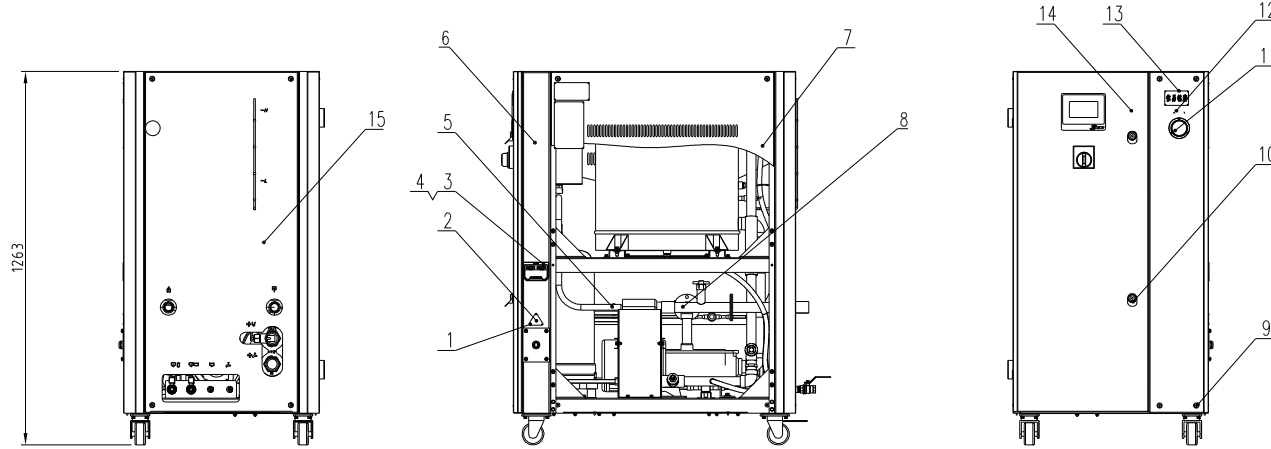

16	SIC-17W-R2-ALL-05	Top panel	SPCC15	1	
15	SIC-17W-R2-ALL-04	Rear panel	SPCC15	1	
14	SIC-17W-R2-ALL-01	Front door panel	SPCC15	1	
13	YP30804.900700	Shell aluminum complete (snap standard)	2024	1	
12	YP304.25000000	Pump pressure gauge (with aluminum label)	2024	1	
11	YW85001000100	Water pressure gauge 0-10KG	2024	1	
10	YW00816100000	Door lock (8816-1, black, with key)	Assembly	1	
9	YW620635000000	Cross recess large flat head screw JISIII M6x5	2024	18	
8	SIC-17W-R2-B-ALL	Water system	Assembly	1	
7	SIC-17W-R2-ALL-03	Right side panel	SPCC15	1	
6	SIC-17W-R2-A-ALL	Frame	Assembly	1	
5	SIC-17W-R2-C-ALL	Refrigerant system	Assembly	1	
4	YR4.004.8500000	RS485 enclosure	Assembly	1	
3	YE9004.8501200	RS-485 communication interface board	Assembly	1	
2	YP310516500000	3-phase 400V delta power supply	2024	1	
1	YW690205000000	Rivet GB/T 827 2x5		18	
序号	代号	名称	材质	数量	备注

Technical Requirements

1. Assemble sheet metal parts with nuts. Ensure the sheet metal is free of scratches and the complete unit operates with low vibration.
2. The refrigerant system shall sustain an operating pressure of 4.2 MPa with no leakage.
3. The water system shall remain leak-tight under an operating pressure of 7 bar.
4. All systems shall be fully assembled, and the equipment surface shall be cleaned thoroughly.

				制图	版号	H	标题	SIC-17W-R2	图号	SIC-17W-R2-ALL	比例	1:16	数量	1
				设计	核		总装图						材质	组合件
(H1)	/	见本图	20260427	校对	准								表面要求	/
标记	更改前	更改后	更改人	日期	审核	日期	20190815	信易电热机械股份有限公司 Shini Plastics Technologies, Inc.		物料号			/	

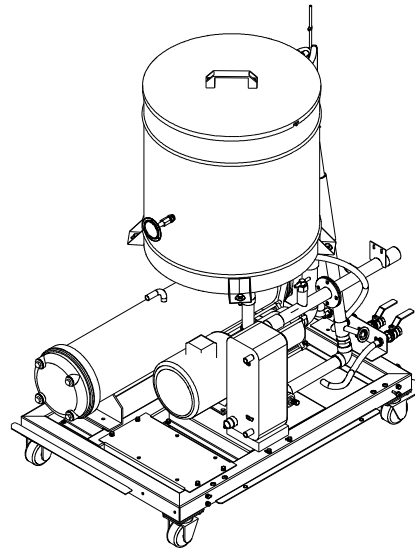
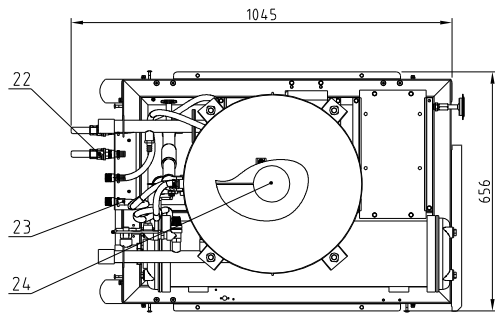
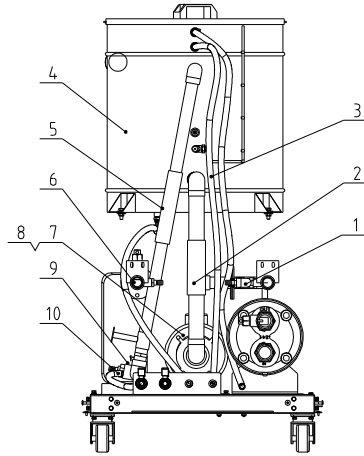
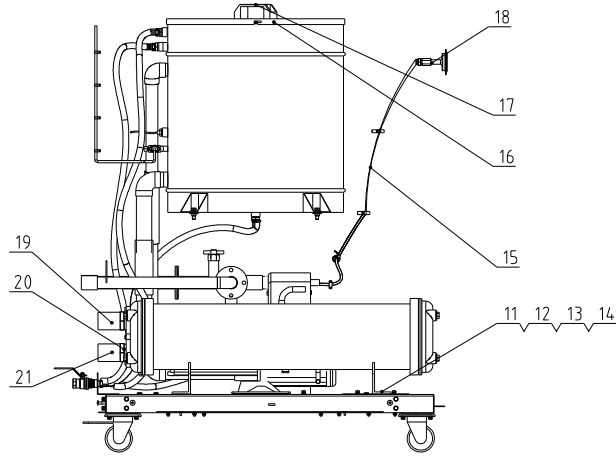

Technical Requirements

- 1 Wrap PTFE tape for sealing at all threaded connections.
- 2 Use special adhesive for PVC-U pipe joints. No leakage shall occur under pressure up to 0.7 MPa
- 3 Do not fill water within 24 hours after assembly.

24	YW59010200000	1/2' float switch	Assembly	1	
23	YW02182900000	Stainless steel pipe bundle (16-29)	Assembly	8	
22	YW50001208200	1/2' brass ball valve (internal f thread)	Assembly	3	
21	YW500015014.00	Galvanized female thread straight coupling 1/4"	Q235A	1	
20	YW50001500100	Pipe male adapter 1-1/2"	Q235A	2	
19	YW59010200000	Galvanized pipe tee 1-1/2"x1/4"	Q235A	1	
18	YW85001000100	Water pressure gauge	Assembly	1	
17	BW20012000040	Aluminum square handle 120L	Assembly	1	
16	SIC-33A-R2-B-08	Water tank cover	Assembly	1	Borrowed
15	YR60620000100	Transparent air hose (20m per roll)	Assembly	2M	
14	YW60082500100	Hex head bolt GB/T6783 M6x25	4.8	8	
13	YW65008000100	Standard spring washer GB/T93 8	Mn65	8	
12	YW66082200100	Grade C large washer GB/T96 8	140Hv	16	
11	YW64080600000	Hex nut GB/T6170 M8	5.0	8	
10	YW02000400000	1/4-inch stainless steel pipe bundle	Assembly	2	
9	YW85043600000	Flow switch SEN-BP43W	Assembly	2	
8	YM214503004.00	Nanyuan water pump SHP4-50	Assembly	1	High pressure use
7	YM214403006.00	Nanyuan water pump SHP4-40	Assembly	1	Medium pressure use
6	SIC-17W-R2-B-02	Return pipe assembly	Assembly	1	
5	SIC-17W-R2-B-03	Plate hot exchange outlet pipe assembly	Assembly	1	
4	SIC-17W-R2-B-07	Water tank body	PVC-U	1	
3	YR60051000000	Wire reinforced rubber hose 1/2"	Assembly	3M	
2	SIC-17W-R2-B-04	Pump suction pipe assembly	Assembly	1	
1	SIC-17W-R2-B-05	Water outlet pipe assembly	Assembly	1	

序号	代号	名称	材质	数量	备注
		标题 SIC-17W-R2	图号 SIC-17W-R2-B-ALL	比例 1:13	数量 1
		水系统		材质	组合件
(E1)	/	见本图	20260427	表面要求	/
标记	更改前	更改后	更改人	日期	审核
				日期	20191011

SHINI 信易电热机械股份有限公司
Shini Plastics Technologies, Inc.

Cooling capacity/water outlet temp. 7℃	Cooling capacity/water outlet temp. 10℃	Cooling capacity/water outlet temp. 15℃	Total power (middle/high pressure)	Cooling water inlet(finch)	Cooling water outlet(finch)	Chilled water inlet (inch)	Chilled water outlet (inch)	Drainage outlet(finch)	Water tank refill port (inch)	Cooling water flow (L/min)	Flow rate of chilled water(L/min)	Water tank capacity(L)	Weight(kg)	Ver
24kw	27kw	29kw	6.08kw	Rc2	Rc2	Rc125	Rc125	Rc1/2	Rc1/2	103.9	83.1	150	330	C

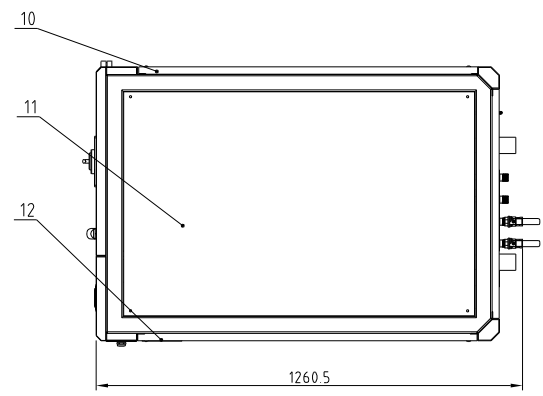
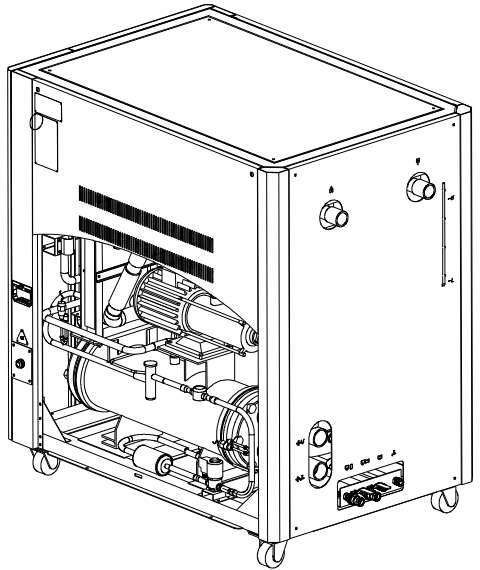
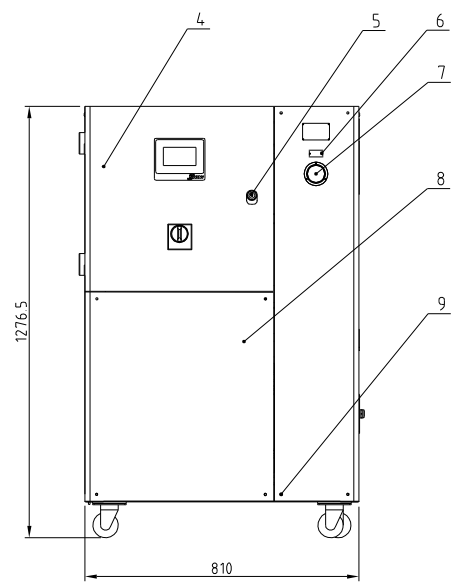
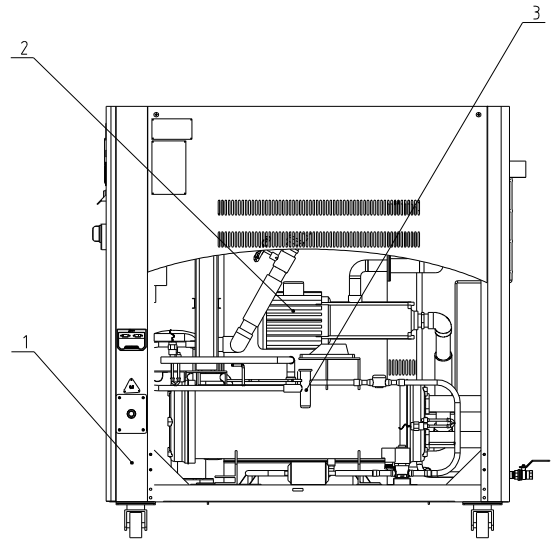
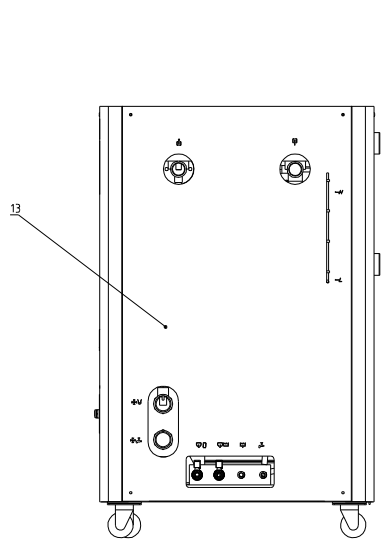

Technical Requirements
 1 Fasten all screws on sheet metal parts to specified torque with no loosening
 2 Avoid scratching PVC-U fittings, bond PVC-U pipes with dedicated adhesive to ensure leak-free joints
 3 Use specified brazing filler for copper pipe welding, and all welds shall be leakproof.

13	SIC-38W-R2-ALL-04	Rear panel	SPCC15	1	Borrowed
12	SIC-38W-R2-ALL-03	Right side panel	SPCC15	1	Borrowed
11	SIC-38W-R2-ALL-05	Top panel	SPCC15	1	Borrowed
10	SIC-38W-R2-ALL-02	Left side panel	SPCC15	1	Borrowed
9	YW62063500000	Large flat head screw M6X35	4.8	20	
8	SIC-38W-R2-ALL-06	Lower front door panel	SPCC15	1	Borrowed
7	YW63030600000	Cross recess screw M3X6	4.8	3	
6	YW69020500000	Rivet 2X5	4.8	13	
5	YW00816100000	Door lock	Assembly	1	
4	SIC-38W-R2-ALL-01	Upper front door panel	SPCC15	1	Borrowed
3	SIC-29W-R2-C-ALL	Refrigerant system	Assembly	1	
2	SIC-29W-R2-B-ALL	Water system	Assembly	1	
1	SIC-29W-R2-A-ALL	Frame assembly	Assembly	1	

					制图	版号	1	标题	SIC-29W-R2	图号	SIC-29W-R2-ALL	比例	1:18	数量	1	
					设计	核准			总装图						材质	组合件
⑪		见本图		20260324	校对										表面要求	/
标记	更改前	更改后	更改人	日期	审核	日期	20190301								物料号	/



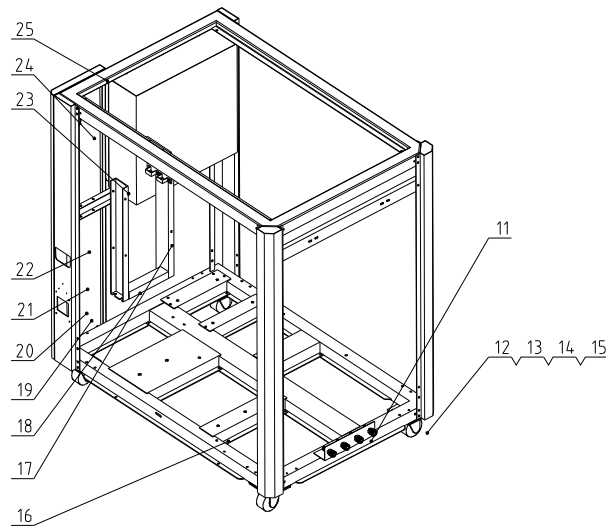
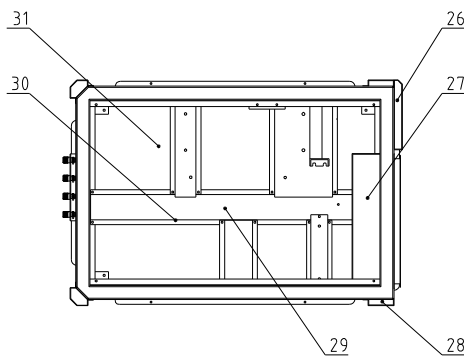
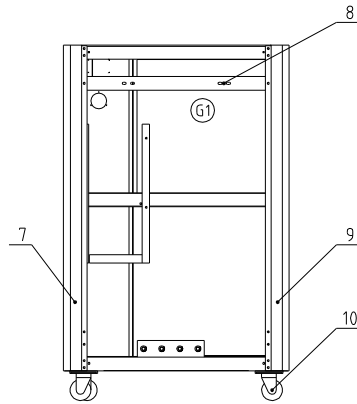
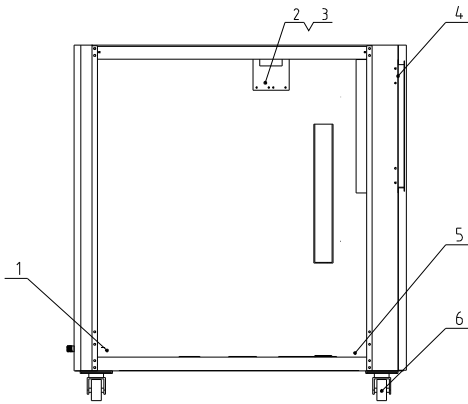

Technical Requirements
Tighten all sheet metal fasteners to specified torque without loosening.

31	SIC-29W-R2-A-08	Filter retainer block	SPCC2.0	2	Borrowed
30	SIC-38W-R2-A-11	Filter mounting beam	SPCC2.0	1	Borrowed
29	SIC-29W-R2-A-ALL-01	Bottom frame combination	Assembly	1	
28	SIC-38W-R2-A-03	Right front pillar	SPCC2.0	1	
27	SIC-38W-R2-A-06	Electric cabinet	SPCC2.0	1	Borrowed
26	SIC-38W-R2-A-01	Surface plate	SPCC2.0	1	Borrowed
25	SIC-38W-R2-A-10	Top frame	SPCC2.0	1	Borrowed
24	SIC-38W-R2-A-02	Left front pillar	SPCC2.0	3	Borrowed
23	SIC-38W-R2-A-08	Front middle crossbeam	SPCC3.0	1	Borrowed
22	YE90048501200	Combination lockset lock B-66 (with lock cylinder)	Assembly	1	
21	YP31051650000	Welding nut (with lock)	Assembly	1	
20	BL02010000020	Wire clamp fixing plate K32 SF-S-01	SPCC2.0	1	
19	YW62051000100	Cross member big flat head screw J3311M6x10	4.8	6	
18	SIC-33A-R2-A-17	Evaporator fixed groove	SPCC3.0	2	Borrowed
17	SIC-33A-R2-A-18	Evaporator retainer plate	SPCC2.0	4	
16	SIC-38W-R2-A-23	Piping beam of liquid pipe solenoid valve	SPCC15	1	Borrowed
15	YW60062000100	Hexagon head bolt GB/T5781 M6x20-L8	4.8	90	
14	YW66061300000	Flat Washer Grade A GB/T97.16	14.0HV	90	
13	YW65006000100	Standard spring washer GB/T93.6	65Mn	90	
12	YW64006003000	Hexagon nut GB/T6170 M6	5.0	46	
11	SIC-33A-R2-A-38	Water collector fixing plate	SPCC2.0	1	Borrowed
10	YW03000300300	Fixed castors 3 "black	Assembly	2	
9	SIC-38W-R2-A-04	Left rear pillar	SPCC2.0	1	Borrowed
8	SIC-38W-R2-A-15	Fixed connection of water inlet and outlet pipe	SPCC2.0	2	Borrowed
7	SIC-38W-R2-A-05	Right rear pillar	SPCC2.0	1	Borrowed
6	YW03000300000	Fixed castors 3 "black	Assembly	2	
5	BL08102100020	Triangle plate (right) SF-04 (with mould)	SPCC2.0	4	
4	YW06203100400	Flange large C203-1 (left) (with mould)	Assembly	2	
3	SIC-039	Sensor fixing plate	SPCC2.0	1	
2	SIC-038	Sensor fixing clamp	SPCC15	2	
1	BL08112000020	Triangle plate (left) SF-03 (with mould)	SPCC2.0	4	Borrowed
序号	代号	名称	材质	数量	备注

①	无	新增传感器固定板	20260313	制图	版号	G	标题	SIC-29W-R2	图号	SIC-29W-R2-A-ALL	比例	1:17	数量	1
②	无	新增传感器固定夹	20260313	设计	核准		机架组合						材质	组合件
③	无	取消进出水管固定新板	20260313	校对	日期								表面要求	/
标记	更改前	更改后	更改人	日期	审核	日期	20190301	SHINI 信易电热机械股份有限公司 Shini Plastics Technologies, Inc.		物料号			/	

Cooling capacity(water outlet temp. 7℃)	Cooling capacity(water outlet temp. 10℃)	Cooling capacity(water outlet temp. 15℃)	Total power (middle/high pressure)	Cooling water inlet(inch)	Cooling water outlet(inch)	Chilled water inlet (inch)	Chilled water outlet (inch)	Drainage outlet(inch)	Water tank refill port (inch)	Cooling water flow (L/min)	Flow rate of chilled water(L/min)	Water tank capacity(L)	Weight(kg)	Ver
29kw	32kw	38kw	8.3/9.0kw	Rc2	Rc2	Rc1.5	Rc1.5	Rc1/2	Rc1/2	136.1	108.9	150	350	C

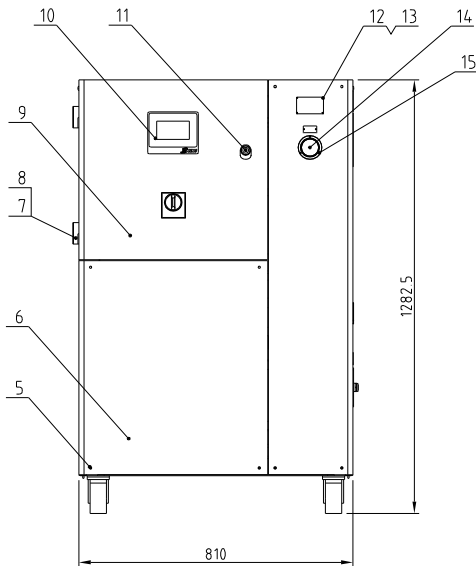
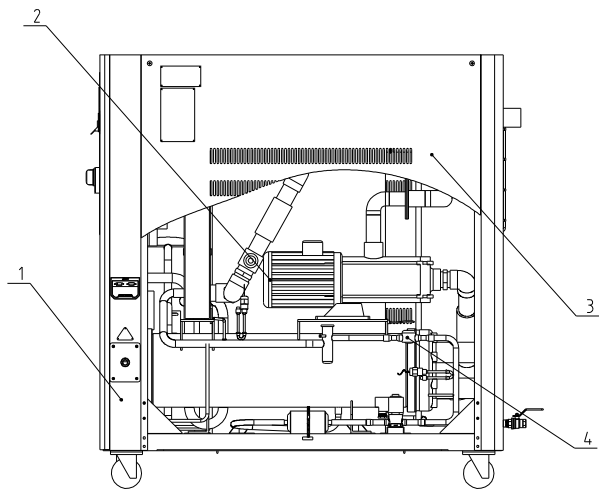

Technical Requirements

- 1 Tighten all sheet metal screws to specified torque to avoid looseness.
- 2 Prevent scratch damage to PVC-U fittings, assemble PVC-U pipes with special adhesive for leak-free joints.
- 3 Use specified brazing filler for copper pipe welding to ensure leakproof welds.

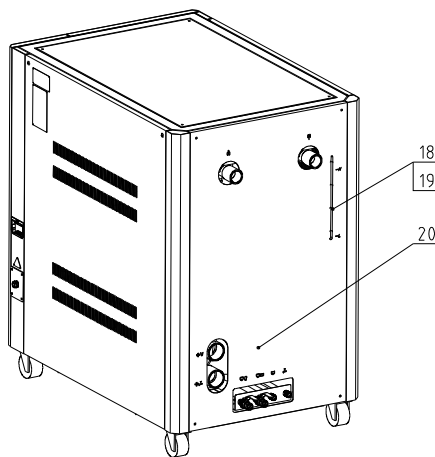
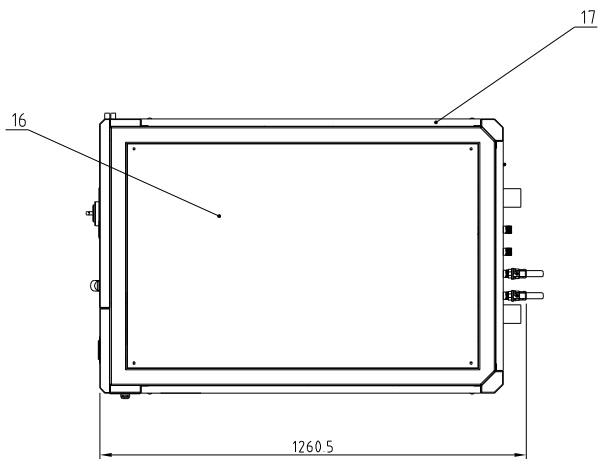

20	SIC-38W-R2-ALL-04	Rear panel	SPCC15	1	
19	YR90000022000	Air conditioning ribbon	Assembly	4	
18	YR60620000100	Transparent air pipe M6	Structural parts	3m	
17	SIC-38W-R2-ALL-02	Left side plate	SPCC15	1	
16	SIC-38W-R2-ALL-05	roof	SPCC15	1	
15	YW63030600000	Cross recessed pan-head screw M4x6		4.8	3
14	YP304.25000000	Pump pressure gauge	Assembly	1	
13	YP30804.900700	Nameplate of machine	Assembly	1	
12	YW69020500000	Rivet 2 X 5		4.8	21
11	YW00816100000	Door lock	SPCC15	1	
10	YE80317501900	Chiller controller	Assembly	1	
9	SIC-38W-R2-ALL-01	Front upper door panel	SPCC15	1	
8	YW62051000100	Cross recessed big flat head screw M4x10		4.8	8
7	YW062031004.00	Hinge large CL203-1 (left)	Structural parts		2
6	SIC-38W-R2-ALL-06	Front lower door panel	SPCC15	1	
5	YW62063500000	FLAT HEAD SCREW M6x35		4.8	12
4	SIC-38W-R2-C-ALL	Refrigerant system	Assembly	1	
3	SIC-38W-R2-ALL-03	Right side plate	SPCC15	1	
2	SIC-38W-R2-B-ALL	Water system	Assembly	1	
1	SIC-38W-R2-A-ALL	Rack assembly	Assembly	1	
序号	代号	名称	材质	数量	备注

				制图		版号	1	标题	SIC-38W-R2	图号	SIC-38W-R2-ALL	比例	1:18	数量	1
				设计		核准		总装图						材质	组合件
⑪		见本图		20260305	校对			SHINI	信易电热机械股份有限公司 Shini Plastics Technologies, Inc.		表面要求		/		
标记	更改前	更改后	更改人	日期	审核	日期	20190301				物料号		/		

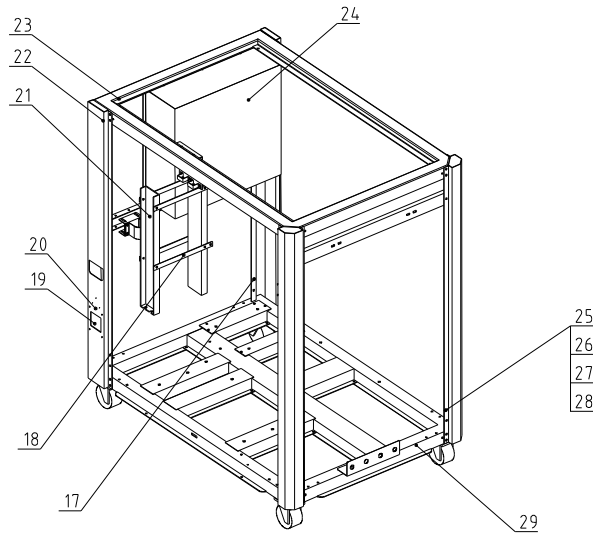
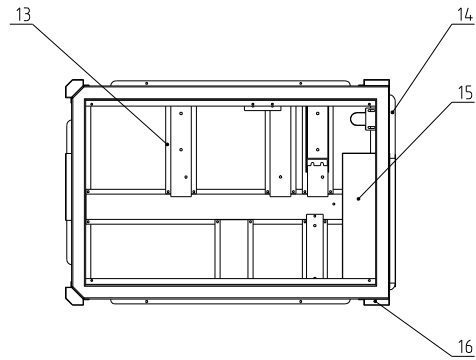
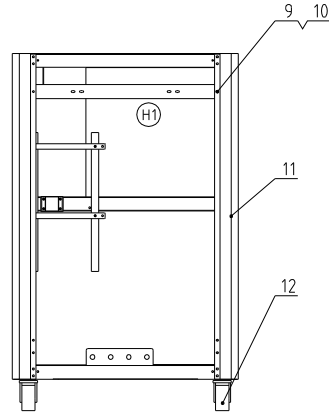
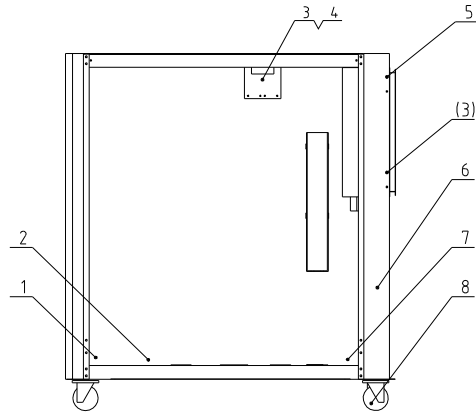

Technical Requirements
Tighten all fasteners of sheet metal parts to specified torque with no looseness

29	SIC-38W-R2-A-ALL-01	Bottom frame combination	Assembly	1	
28	YW64000600300	Hexagon nut GB/T6170 M6	5	74	
27	YW65006000100	Standard spring washer GB/T93 6	65Mn	118	
26	YW6600613000000	Flat Washer Grade A GB/T97.16	14.0HV	118	
25	YW60062000100	Hexagon head bolt GB/T5781 M6x20-4.8	4.8	118	
24	SIC-38W-R2-A-07	Electric appliance base plate	SECC15	1	
23	SIC-38W-R2-A-10	Top frame	SPCC2.0	1	
22	SIC-38W-R2-A-03	Right front pillar	SPCC2.0	1	
21	SIC-38W-R2-A-08	Front middle crossbeam	SPCC2.0	1	
20	YP31051650000	Welding wire E6013 (Welding wire)		1	
19	BL02010000020	Wire clamp fixing plate K32 SP-5-01	SPCC2.0	1	
18	SIC-38W-R2-A-20	Fixed plate of plate change	SPCC3.0	2	
17	SIC-33A-R2-A-18	Evaporator retainer plate	SPCC2.0	4	Borrowed
16	SIC-38W-R2-A-02	Left front pillar	SPCC2.0	1	
15	SIC-38W-R2-A-06	Electric cabinet	SPCC15	1	
14	SIC-38W-R2-A-01	Surface plate	SPCC2.0	1	
13	SIC-38W-R2-A-12	Filter retainer block	SPCC3.0	1	
12	YW03000300300	Fixed castors 3 "black	Assembly	2	
11	SIC-38W-R2-A-04	Left rear pillar	SPCC2.0	1	
10	SIC-38W-R2-A-15	Fixing beam of water inlet and outlet pipe	SPCC2.0	1	
9	SIC-38W-R2-A-05	Right rear pillar	SPCC2.0	2	
8	YW03000300000	Movable brake castors black	Assembly	2	
7	BL08102100020	Triangle plate (right) SIC-043 (with mold)	SPCC2.0	4	
6	YE9004-8501200	Insulation blanket heat 8-10 (heat heat pipe covered)	Assembly	1	
5	YW620510000100	Tube round by the hot water 150 (hot hot water end)	4.8	6	
4	SIC-039	Sensor fixing plate	SPCC2.0	1	
3	SIC-038	Sensor fixing clamp	SPCC15	2	
2	SIC-38W-R2-A-23	Fixing beam of liquid pipe solenoid valve	SPCC15	1	Option
1	BL08112000020	Triangle plate (left) SIC-043 (with mold)	SPCC2.0	4	
序号	代号	名称	材质	数量	备注

Ⓜ3	无	新增传感器固定板	20260313	制图		版号	H	标题	SIC-38W-R2	图号		比例	1:17	数量	1
Ⓜ2	无	新增传感器固定夹	20260313	设计		核准		机架组合		SIC-38W-R2-A-ALL		材质	组合件		
Ⓜ1	无	取消进出水管固定新板	20260313	校对		审核						表面要求	/		
标记	更改前	更改后	更改人	日期	审核	日期	20190301					物料号	/		

SHINI 信易电热机械股份有限公司
Shini Plastics Technologies, Inc.

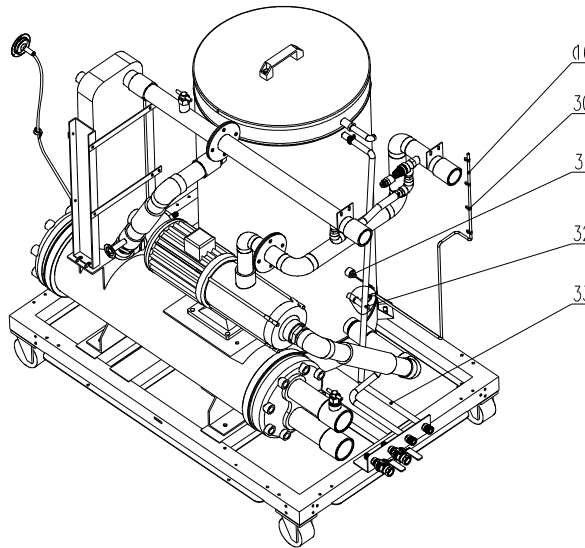
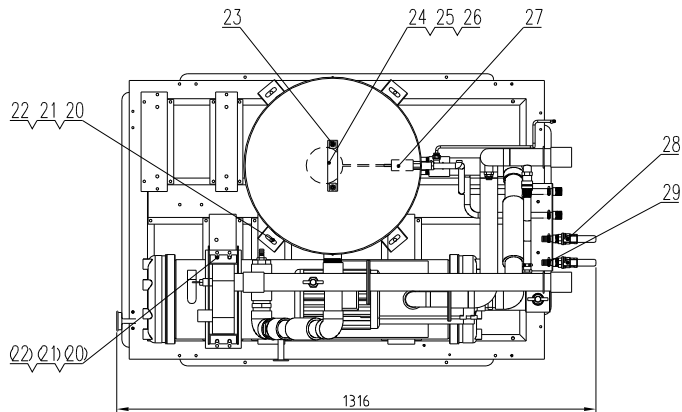
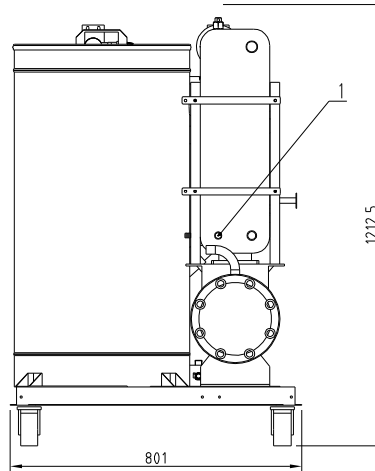
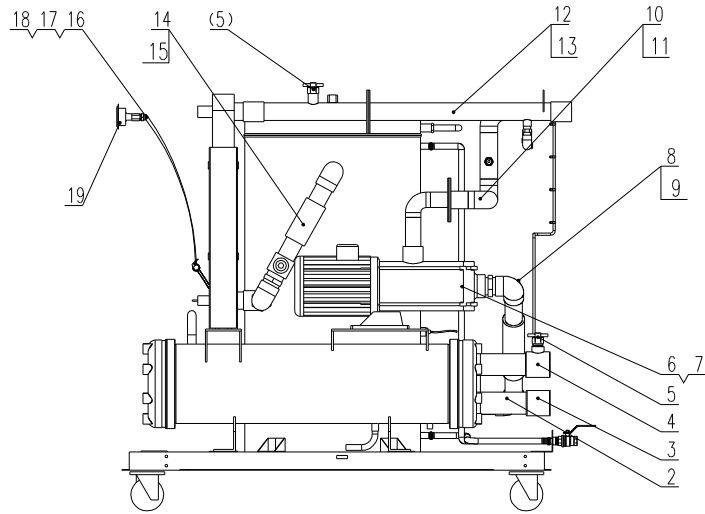

Technical requirements:

- 1 Wrap the thread connection with raw material tape for sealing.
- 2 PVC-U plastic water pipe shall be connected with special adhesive.
- 3 No leakage is allowed within 0.7Mpa.
- 4 Water shall not be supplied under pressure for 24 hours after assembly.

33	YR60051000000	Steel wire hose 1/2 inch	Assembly	2m	
32	YE90711000000	Water temperature probe 4 X 1/8, 1/8" PT	Assembly	1	
31	YE90001600000	Side panel plastic extruded liquid level switch BS	Structural parts	1	Option
30	YR90000022000	Air conditioning black ribbon	Structural parts	4	
29	YW02182900000	Stainless steel tube bundle 18-28M	Assembly	10	
28	YW50001208200	Copper ball valve 1/2 inch (internal 6 thread)	Assembly	2	
27	YW59010200000	Float switch copper 1/2"	Assembly	1	
26	SIC-33A-R2-B-08	Water tank cover	Assembly	1	Borrowed
25	SIC-57W-R2-B-07	water tank	Assembly	1	Borrowed
24	BW20012000040	Aluminum square handle	Assembly	1	
23	YW61062000000	Hexagon socket screw M6x20	SUS	2	
22	YW60082000200	Hexagon bolt M8x20	8.8	12	
21	YW66081600000	Flat washer (8.4 * 16 * 1.6)	140HV	12	
20	YW65008000100	Spring washer GB/T93 8	65Mn	12	
19	YW85001000100	Pressure gauge 0-10KG	Assembly	1	
18	BH12060701710	PT to 1/4" H connector	H58	1	
17	YW80061400200	L-shaped threaded joint AP6-1/4	Assembly	3	
16	YR60620000100	Transparent air pipe M6	Assembly	1m	
15	SIC-38W-R2-B-11	Optional plate water outlet pipe combination	Assembly	1	Option
14	SIC-38W-R2-B-03	Combination of plate exchange outlet pipe	Assembly	1	
13	SIC-38W-R2-B-10	Optional return pipe combination	Assembly	1	Option
12	SIC-38W-R2-B-02	Return pipe assembly	Assembly	1	
11	SIC-38W-R2-B-13	Optional pump outlet pipe combination	Assembly	1	Option
10	SIC-38W-R2-B-05	Pump outlet pipe combination	Assembly	1	
9	SIC-38W-R2-B-12	Optional pump suction pipe combination	Assembly	1	Option
8	SIC-38W-R2-B-04	Pump suction pipe assembly	Assembly	1	
7	YM21850300100	Nanyuan Water Pump SHP8-50	Assembly	1	High pressure use
6	YM21840300100	Nanyuan Water Pump SHP8-40	Assembly	1	Medium pressure use
5	YW85043600000	Flow switch	Assembly	2	
4	YW52023401300	Galvanized water pipe tee 2" X 3/4"	Q235A	1	
3	YW51000200000	Galvanized water pipe straight inner thread 2"	Q235A	1	
2	SIC-38W-R2-B-08	Condensate inlet and outlet pipe	Q235A	2	
1	YE90001400700	Anti-freeze temperature sensing line 4 1/8, 1/4" PT	Structural parts	1	

序号	代号	名称	材质	数量	备注
		标题 SIC-38W-R2			
		图号 SIC-38W-R2-B-ALL			
		水系统			
		SHINI 信易电热机械股份有限公司			
		Shini Plastics Technologies, Inc.			
		表面要求			
		物料号			

制图	设计	校对	审核	日期

版号	日期
E	

标记	更改前	更改后	更改人
(E1)			

日期	日期
20260305	

日期	日期
20190301	

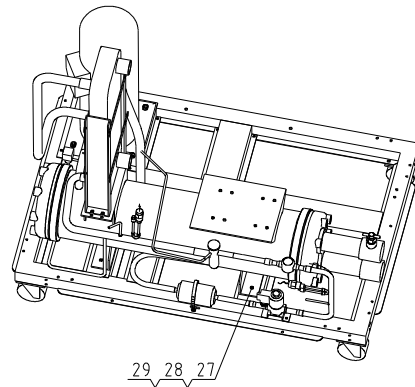
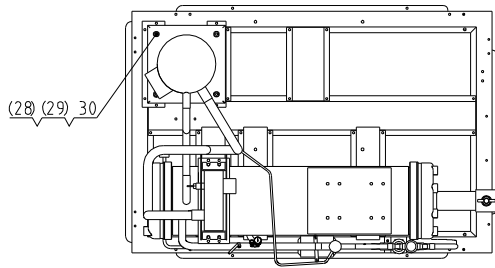
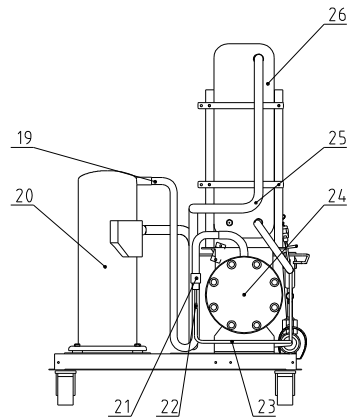
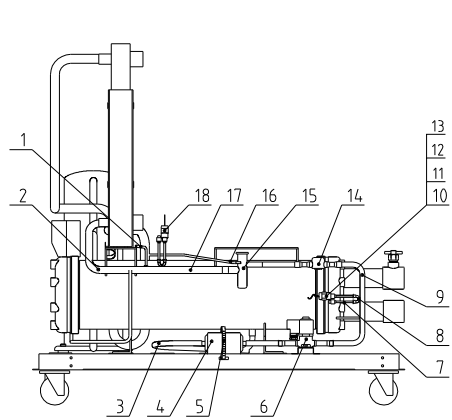

Technical Requirements

1. Brazing filter metal with silver content of minimum 20% is recommended for copper-to-stainless steel joints, and no less than 5% silver for copper-to-copper brazing. All components shall be mounted firmly and neatly. Higher brazing proficiency is required when using low-phosphorus brazing rods.
2. Anti-oxidation protection shall be applied during brazing. No oxide scale, slag or foreign debris shall remain inside piping after brazing, and all brazed joints shall be smooth.
3. After assembly, pressurize the refrigerant system with nitrogen at 2.5 MPa for pressure holding test. The pressure gauge reading shall remain unchanged within 10 hours.
4. Wrap thermal insulation cotton around low-temperature copper pipes and evaporator surface.
5. Thermal insulation treatment shall also be applied to temperature probes.

30	YW60085000000	Hexagon head bolt GB/T5783 M6*50-8.8	4.8	4	
29	YW66082200100	Large washer Class C GB/T926 (4.4x24)	14.0HV	8	
28	YW65008000100	Standard spring washer GB/T93 8	65Mn	8	
27	YW60082500100	Hexagon bolt GB/T5783 M6*25-12.9	4.8	4	
26	SIC-38W-R2-C-01	Plate type evaporator	Assembly	1	
25	SIC-38W-R2-C-03	Return air pipe	TP2M	1	
24	SIC-38W-R2-C-02	condenser	Assembly	1	
23	SIC-38W-R2-C-08	Bypass valve outlet pipe	TP2M	1	
22	YW51635000100	Large pipe elbow, low temperature	TP2M	1	
21	YE90042402100	Bypass solenoid valve PDP-4M10	Assembly	1	
20	YM70012201600	Gu Lun Compressor ZP12KCE	Assembly	1	
19	SIC-38W-R2-C-04	Exhaust pipe	TP2M	1	
18	YE15200300400	Head nut M6*10-100 9mm diameter (10)	Structural parts	1	
17	SIC-38W-R2-C-07	Outlet pipe of expansion valve	TP2M	1	
16	YS30063500000	Equalizing pipe of expansion valve	TP2M	1	
15	YW85712500000	Expansion valve BAET-1/2	Assembly	1	
14	YW85001500100	Hydroscope HMI-1TT5	Assembly	1	Option
13	YR60001100100	Pressure hose RQ-01 (SHI)	Assembly	2M	
12	YW80716200100	Pressure sensor copper straight-through	Assembly	2	
11	YW80000100200	Straight-through SZT-41 (with diaphragm)	Assembly	2	
10	YE15200500400	Head nut M6*10-100 9mm diameter (10)	Structural parts	1	
9	SIC-38W-R2-C-06	Filter outlet pipe	TP2M	1	
8	YW59001400600	Copper T-shaped joint 1/4" TP2M	TP2M	2	
7	YW85010400300	Liquid filling needle valve 1/4 inch (for R404A)	Assembly	4	
6	YE90207500500	Liquid pipe solenoid valve 30082757	Assembly	1	Option
5	YW02000400000	Stainless steel tube bundle 4 inches	SUS303	1	
4	YW85016500100	Drying filter EK 165S	Assembly	1	
3	SIC-38W-R2-C-05	Liquid inlet pipe of filter	TP2M	1	
2	SIC-38W-R2-C-07	Outlet pipe of expansion valve	TP2M	1	
1	YS30063500000	Soft copper pipe φ 6.35 ± 0.6	TP2M	0.2	

(F1)
(F1)
(F1)

序号	代号	名称	材质	数量	备注
		标题 SIC-38W-R2 冷媒系统		比例 1:15	数量 1
		图号 SIC-38W-R2-C-ALL		数量 1	备注
(F1)	无	新增零件		20260305	设计 校对
标记	更改前	更改后	更改人	日期	审核
				20190301	核准
		SHINI 信易电热机械股份有限公司 Shini Plastics Technologies, Inc.		表面要求	/
				物料号	/

Cooling capacity/water outlet temp. 7℃	Cooling capacity/water outlet temp. 10℃	Cooling capacity/water outlet temp. 15℃	Total power (middle/high-pressure)	Cooling water inlet(inch)	Cooling water outlet(inch)	Chilled water inlet (inch)	Chilled water outlet (inch)	Drainage outlet(inch)	Water tank refill port (inch)	Cooling water flow L/min	Flow rate of chilled water(L/min)	Water tank capacity(L)	Weight(kg)	Ver.
45kw	49kw	57kw	11.95/12.55kw	Rc2	Rc2	Rc1.5	Rc1.5	Rc1/2	Rc1/2	204	163.4	150	44.0	C

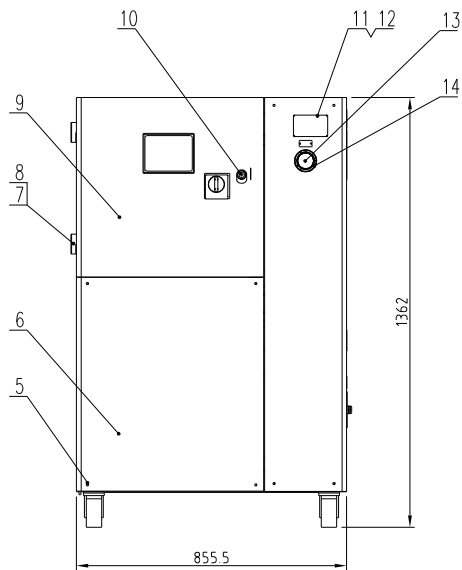
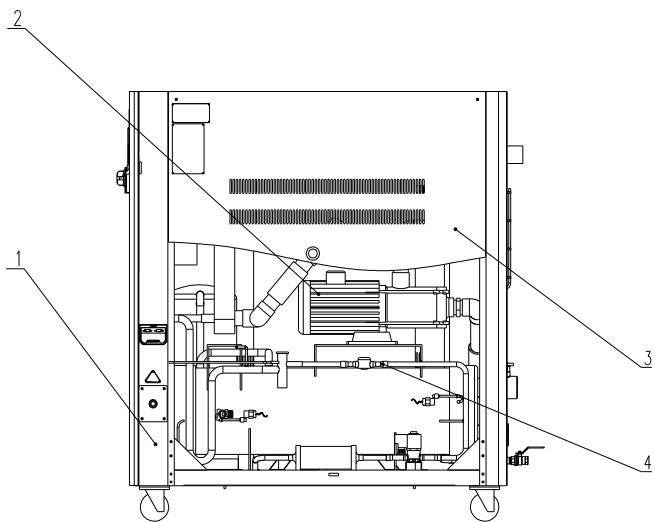

Technical Requirements
 1. Tighten all sheet metal fasteners to specified torque to eliminate looseness.
 2. Avoid scratching PVC-U fittings; bond PVC-U pipes with special adhesive for leak-tight connections.
 3. Use designated brazing rods for copper pipe welding to ensure leak-free weld joints.

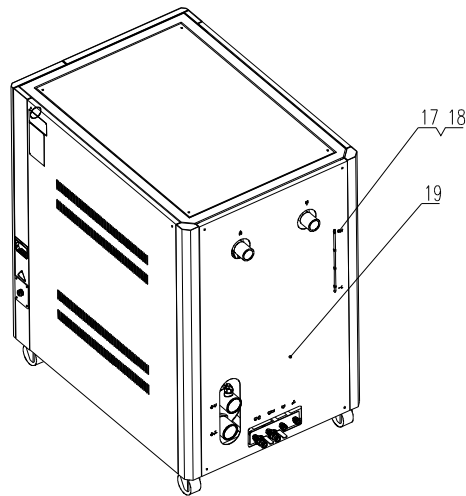
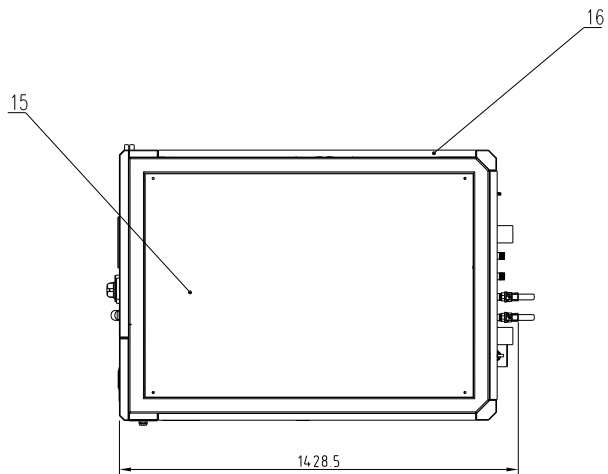

19	SIC-57W-R2-ALL-05	Rear panel	SPCC15	1	
18	YR90000022000	Air conditioning ribbon		4	
17	YR60620000100	Transparent air pipe M6	Structural parts	3m	
16	SIC-57W-R2-ALL-03	Left side plate	SPCC15	1	
15	SIC-57W-R2-ALL-06	roof	SPCC15	1	
14	YW63030600000	Cross recessed pan-head screw M4x6	4.8	3	
13	YP30425000000	Pump pressure gauge	Assembly	1	
12	YP30804.900700	Nameplate of machine	Assembly	1	
11	YW69020500000	Rivet 2 X 5	4.8	17	
10	YW00816100000	Door lock	SPCC15	1	
9	SIC-57W-R2-ALL-01	Front upper door panel	SPCC15	1	
8	YW62051000100	Cross recessed big flat head screw M4x6	4.8	8	
7	YW062031004.00	Hinge large CL203-1 (left)	Structural parts	2	
6	SIC-57W-R2-ALL-02	Front lower door panel	SPCC15	1	
5	YW62063500000	Cross recessed big flat head screw M4x5	4.8	20	
4	SIC-57W-R2-C-ALL	Refrigerant system	Assembly	1	
3	SIC-57W-R2-ALL-04	Right side plate	SPCC15	1	
2	SIC-57W-R2-B-ALL	Water system	Assembly	1	
1	SIC-57W-R2-A-ALL	Rack assembly	Assembly	1	

				制图		版号	1	标题	SIC-57W-R2	图号	SIC-57W-R2-ALL	比例	1:18	数量	1
				设计		核准			总装图					材质	组合件
⑪		见本图	20260313	校对		审核								表面要求	/
标记	更改前	更改后	更改人	日期	审核	日期	20190808							物料号	/



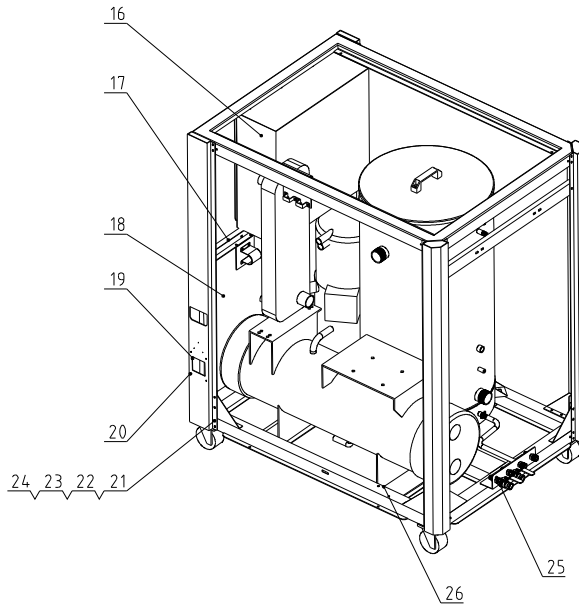
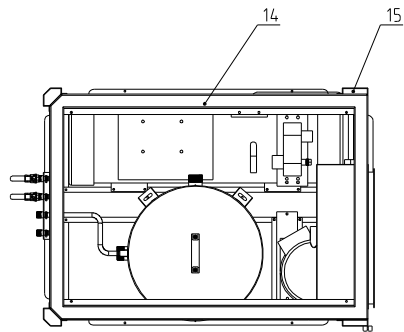
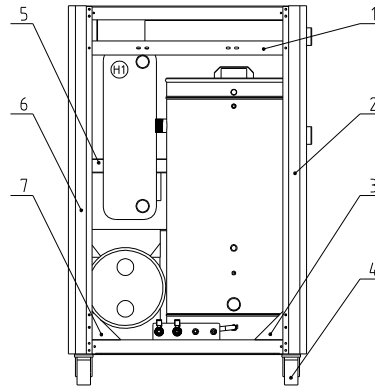
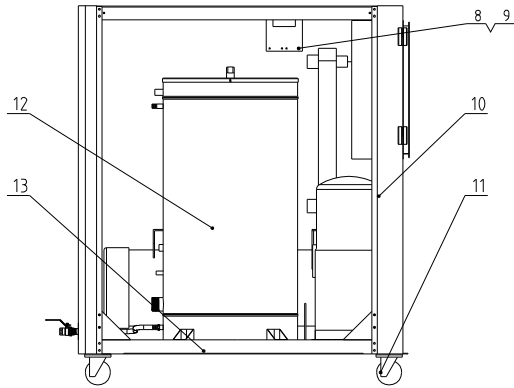

Technical Requirements
Tighten all sheet metal screws to specified torque without looseness.

26	SIC-57W-R2-A-24	Fixing beam of liquid pipe solenoid valve	SPCC15	1	Option
25	SIC-33A-R2-A-38	Water collector fixing plate	H58	1	Borrowed
24	YW66061300000	Flat Washer Grade A GB/T197.16	14.0HV	150	
23	YW65006000100	Standard spring washer GB/T93.6	65Mn	120	
22	YW64.000600300	Hexagon nut GB/T6170 M6	5	120	
21	YW600062000100	Hexagon head bolt GB/T5781 M6*20-L8	4.8	120	
20	YW674.819000000	One round panel self-tapping screw GB/T3632.1 3.6x4.8	4.8	20	
19	BL02010000020	Wire clamp fixing plate M2 3x-5-01	SPCC2.0	1	
18	SIC-57W-R2-A-01	Surface plate	SPCC15	1	
17	SIC-57W-R2-A-08	Front middle crossbeam	SPCC3.0	1	
16	SIC-57W-R2-A-06	Electric cabinet	SPCC15	1	
15	SIC-57W-R2-A-03	Right front pillar	SPCC2.0	1	
14	SIC-57W-R2-A-10	Top frame	SPCC2.0	1	
13	SIC-57W-R2-A-ALL-01	Bottom frame combination	Assembly	1	
12	SIC-57W-R2-A-07	Electric cabinet base plate	SPCC2.0	1	
11	YW03000300000	Self-tapping screw with flat head and hexagonal base GB/T3632.1 3.6x4.8	SPCC2.0	2	
10	SIC-039	Sensor fixing plate	SPCC2.0	1	
9	SIC-038	Sensor fixing clamp	SPCC15	2	
8	SIC-57W-R2-A-02	Left front pillar	SPCC2.0	1	
7	BL08102100020	Triangle plate (right) SIC-04 (with mold)	SPCC2.0	4	
6	SIC-57W-R2-A-05	Right rear pillar	SPCC2.0	1	
5	SIC-57W-R2-A-16	Fixed frame of plate exchange	SPCC3.0	2	
4	YW03000300300	Fixed castors 3 "black	Assembly	2	
3	BL08112000020	Triangle plate (left) SIC-03 (with mold)	SPCC2.0	4	
2	SIC-57W-R2-A-04	Left rear pillar	SPCC2.0	1	
1	SIC-57W-R2-A-19	Fixing beam of water inlet and outlet pipe	SPCC2.0	1	
序号	代号	名称	材质	数量	备注

⑬	无	新增传感器固定板	20260313	制图		版号	H
⑫	无	新增传感器固定夹	20260313	设计		核准	
⑪	无	取消进出水管固定新板	20260313	校对		审核	
标记	更改前	更改后	更改人	日期	审核	日期	20190301

标题	SIC-57W-R2	图号	SIC-57W-R2-A-ALL	比例	1:17	数量	1
	机架组合					材质	组合件
 信易电热机械股份有限公司 Shini Plastics Technologies, Inc.				表面要求	/		
				物料号	/		

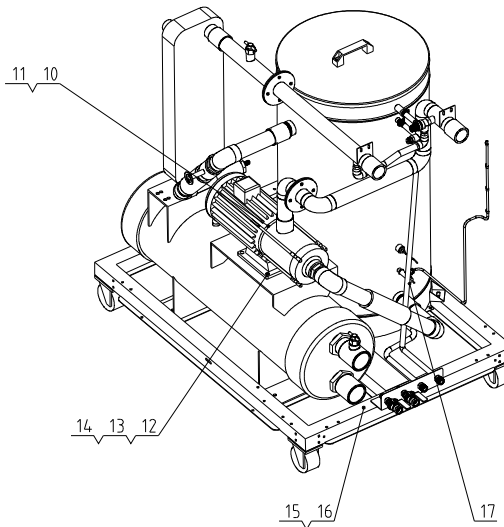
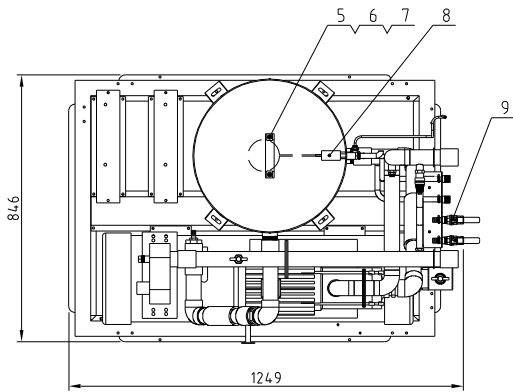
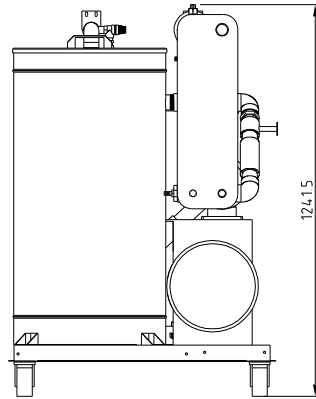
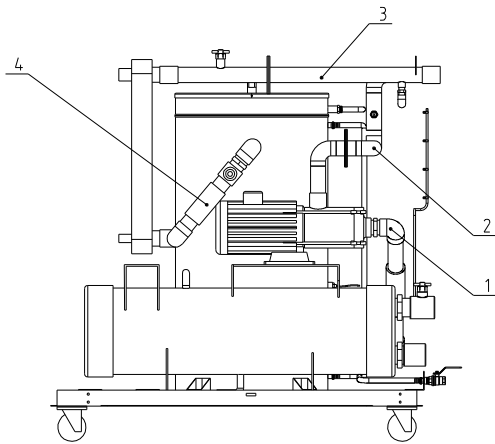

- Technical Requirements
- 1 Wrap PTFE tape for sealing at all threaded connections
 - 2 Use special adhesive for PVC-U plastic pipe joints
 - 3 No leakage shall occur under working pressure up to 0.7 MPa.
 - 4 Do not feed water within 24 hours after assembly

序号	代号	名称	材质	数量	备注
17	YE90001600000	Sub metal plastic ball ball liquid level switch	Structural parts	1	Option
16	YR60051000000	Steel wire hose 1/2"	Assembly	2.5M	
15	YW66061300000	Flat Washer Grade A GB/T97.18	14.0HV	8	
14	YW65006000100	Standard spring washer GB/T93.8	65Mn	8	
13	YW64.080600000	Hexagon nut GB/T6170 MB	5.0	8	
12	YW60082500100	Hexagon bolt MB * 25-12.9	4.8	8	
11	YM21124.000600	Nanyuan Water Pump SHP12-40	Assembly	1	High pressure use
10	YM21123001300	Nanyuan Water Pump SHP12-30	Assembly	1	Medium pressure use
9	YW50001208200	Copper ball valve (2 inch (internal 6 thread)	Assembly	2	
8	YW59010200000	Float switch copper 1/2"	Assembly	1	
7	BW20012000040	Aluminum square handle head	Assembly	1	
6	SIC-33A-R2-B-08	Water tank cover	SUS201	1	Borrowed
5	SIC-57W-R2-B-07	Water tank body	Assembly	1	
4	SIC-57W-R2-B-03	Combination of plate exchange outlet pipe	Assembly	1	
3	SIC-57W-R2-B-02	Return pipe assembly	Assembly	1	
2	SIC-57W-R2-B-05	Pump outlet pipe combination	Assembly	1	
1	SIC-57W-R2-B-04	Pump suction pipe assembly	Assembly	1	

制图	设计	校对	审核	制图日期	设计日期	校对日期	审核日期	版号	标题	图号	比例	数量	备注
								E	SIC-57W-R2	SIC-57W-R2-B-ALL	1:15	1	
								核准	水系统		材质	组合件	
①	更改前	更改后	更改人	日期	日期	日期	日期	20190301	SHINI 信易电热机械股份有限公司 Shini Plastics Technologies, Inc.	表面要求	/		
标记	更改前	更改后	更改人	日期	日期	日期	日期	20190301		物料号	/		

Cooling capacity/water outlet temp. 3℃/1	Cooling capacity/water outlet temp. 10℃/1	Cooling capacity/water outlet temp. 15℃/1	Total power (middle/high pressure)	Cooling water inlet (inch)	Cooling water outlet (inch)	Chilled water inlet (inch)	Chilled water outlet (inch)	Drainage outlet (inch)	Water tank refill port (inch)	Cooling water flow (L/min)	Flow rate of chilled water (L/min)	Water tank capacity (L)	Weight (kg)	Ver
62kw	69kw	76kw	15.98/16.58kw	Rc2	Rc2	Rc2	Rc2	Rc1/2	Rc1/2	272.3	217.9	180	720	C

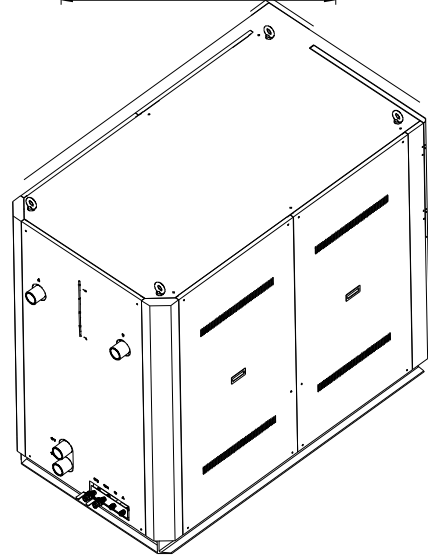
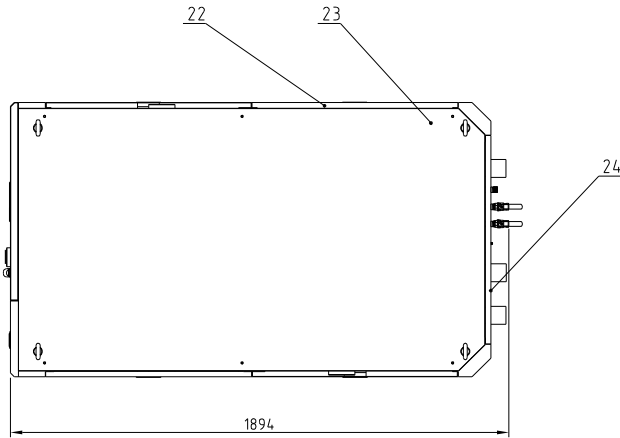
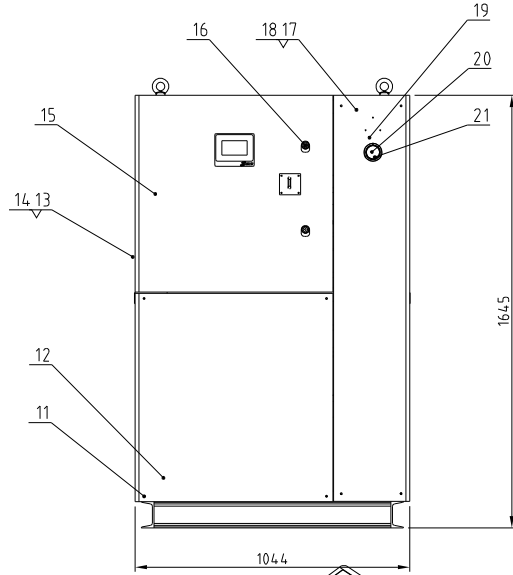
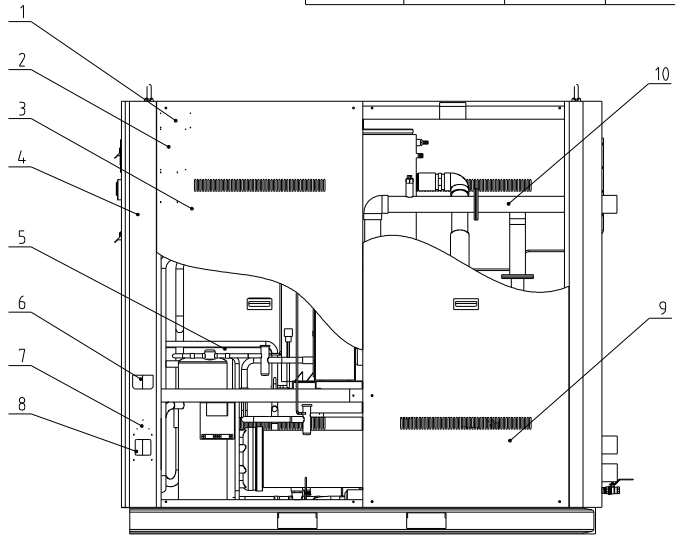

Technical Requirements
 1 Fasten all component screws to specified torque without looseness.
 2 No paint peeling or scratches on outer surfaces.
 3 Panels shall be easy to remove with no interference or jamming during assembly.

26	BH12003300810	Water tank label (material: PVC)	H58	1	
25	YR50012000700	Label (material: PVC)	Assembly	1	
24	SIC-76W-R2-ALL-06	Rear panel	SPCC15	1	
23	SIC-76W-R2-ALL-07	roof	SPCC15	1	
22	SIC-76W-R2-ALL-05	Side plate 2	SPCC15	1	
21	YP30425000000	Pump pressure gauge	Assembly	1	
20	YW63030600000	Cross recessed pan-head screw M6	4.8	3	
19	YP30425000000	Pump Pressure Label	2024	1	
18	YP30804900700	Nameplate of machine	Assembly	1	
17	YW69020500000	Rivet 2 X 5	4.8	21	
16	YW00816100000	Door lock	SPCC15	2	
15	SIC-76W-R2-ALL-01	Front upper door panel	SPCC15	1	
14	YW62051000100	Cross recessed big flat head screw M10	4.8	8	
13	YW06203100400	Hinge large (L203-1 (left))	Structural parts	2	
12	SIC-76W-R2-ALL-02	Front lower door panel	SPCC15	1	
11	YW62063500000	Cross recessed big flat head screw M6.5	4.8	26	
10	SIC-76W-R2-B-ALL	Water system	Assembly	1	
9	SIC-76W-R2-ALL-04	Side plate 1	SPCC15	2	
8	BL02010000020	Wire clamp fixing plate M2	SPCC15	1	
7	YP31051650000	Delta power supply 3 φ 400V	Structural parts	1	
6	YR40048500000	Housing RS485 Rev 0	Assembly	1	
5	SIC-76W-R2-C-ALL	Refrigerant system	Assembly	1	
4	SIC-76W-R2-A-ALL	Rack assembly	Assembly	1	
3	SIC-76W-R2-ALL-03	Nameplate side plate	SPCC15	1	
2	YP31018600000	Notes Label	Structural parts	1	
1	YP31115800400	Aluminum plate label for maintenance of filter	Structural parts	1	

制图	版号	1	标题	SIC-76W-R2	图号	SIC-76W-R2-ALL	比例	1:18	数量	1	备注		
设计	核准		总装图										
⑪ 更改前	见本图	更改后	更改人	日期	20260515	审核	日期	20210625	表面要求	/	物料号	/	
标记	更改前	更改后	更改人	日期	审核	日期	20210625	SHINI 信易电热机械股份有限公司 Shini Plastics Technologies, Inc.		表面要求	/	物料号	/

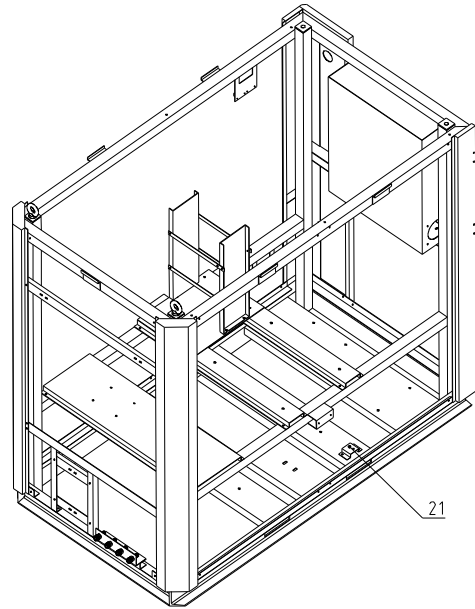
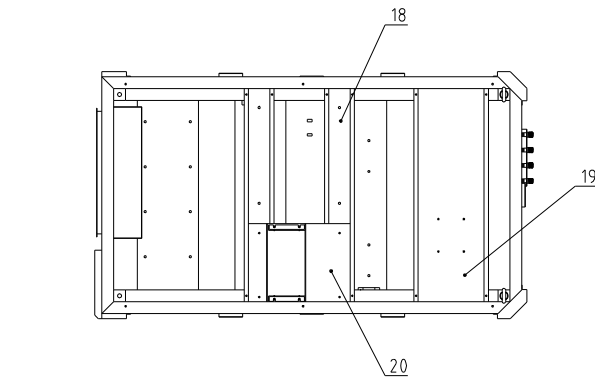
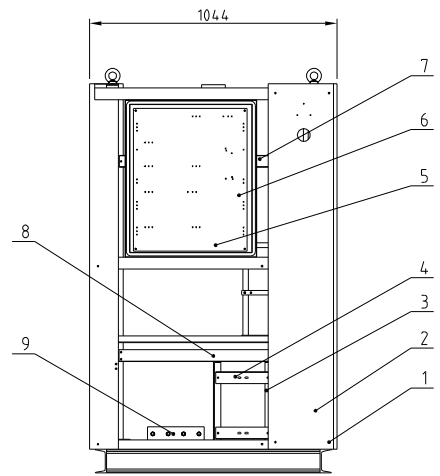
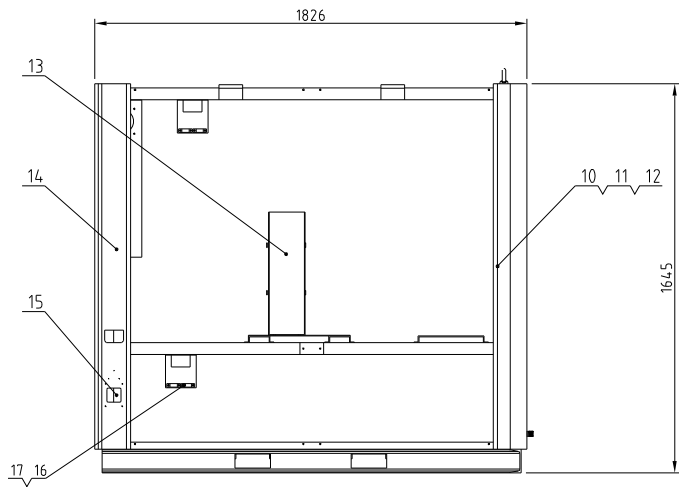

21	SIC-76W-R2-A-28	Fixing beam of liquid pipe solenoid valve	SPCC15	2	Option
20	SIC-76W-R2-A-13	Evaporator support plate	SPCC3.0	1	
19	SIC-76W-R2-A-11	Water pump support beam	SPCC3.0	1	
18	SIC-76W-R2-A-12	Water tank support beam	SPCC3.0	2	
17	SIC-039	Sensor fixing plate	SPCC2.0	2	
16	SIC-038	Sensor fixing clamp	SPCC15	4	
15	BL02010000020	Wire clamp fixing plate K32 SC-S-01	4.8	1	
14	SIC-76W-R2-A-ALL-01	Frame welding drawing	Assembly	1	
13	SIC-76W-R2-A-15	Fixed frame of plate exchange	SPCC3.0	2	
12	YW66061300000	Flat Washer Grade A GB/T97.16	4.8	20	
11	YW65006000100	Standard spring washer GB/T93.6	4.8	20	
10	YW60062000100	Hexagon head bolt GB/T5781 M20-4.8	4.8	20	
9	SIC-33A-R2-A-38	COLLECTOR RETAINING PLATE	SPCC2.0	1	Borrowed
8	SIC-76W-R2-A-20	Condenser water pipe fixing beam	SPCC2.0	1	
7	SIC-76W-R2-A-23	Fixed beam of suspension water inlet and outlet pipe	SPCC2.0	1	
6	SIC-76W-R2-A-07	Electric cabinet	SPCC15	1	
5	SIC-76W-R2-A-08	Electronic control base plate	SPCC15	1	
4	SIC-114 W-R2-A-22	Condenser fixing plate	SPCC2.0	2	Borrowed
3	SIC-76W-R2-A-18	Condenser water pipe fixing beam	SPCC3.0	2	
2	SIC-76W-R2-A-01	Surface plate	SPCC15	1	
1	YW62063500000	Cross recessed big flat head screw JIS11Mx35	4.8	4	
序号	代号	名称	材质	数量	备注

Technical Requirements
 1. All fastening screws for components shall be tightened to the standard torque without loosening
 2. The exterior surface shall be free of paint peeling, scratches and damages
 3. The panels shall be easy to assemble and disassemble without interference or friction jamming

制图	设计	校对	审核	制图日期	设计日期	校对日期	审核日期
				20260515			
(H1)	/	新增钣金件					
标记	更改前	更改后	更改人	日期	日期	日期	20210625

标题	图号	比例	数量	备注
SIC-76W-R2 机架组合	SIC-76W-R2-A-ALL	1:20	1	
 信易电热机械股份有限公司 Shini Plastics Technologies, Inc.		表面要求		/
		物料号		/

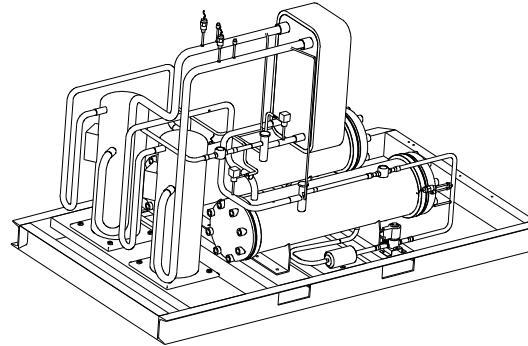
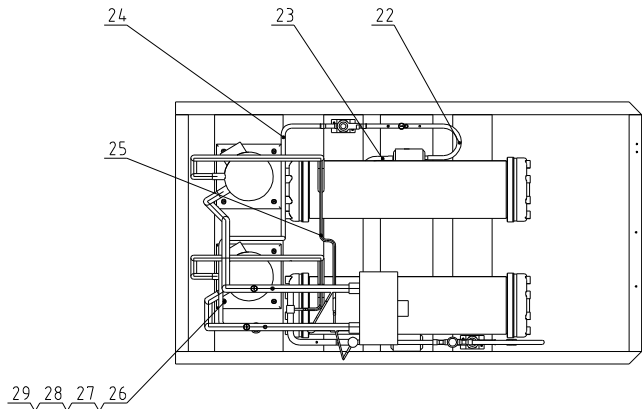
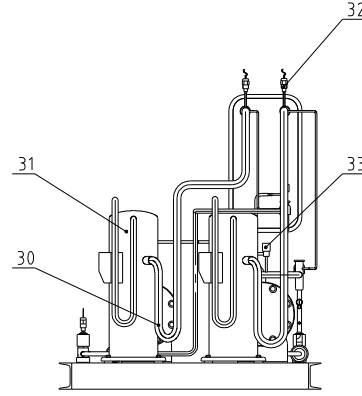
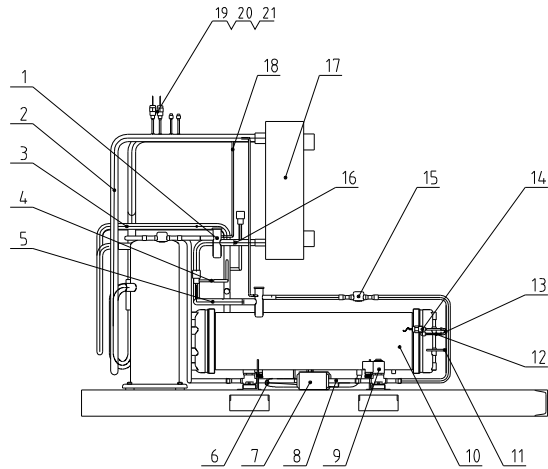

Technical Requirements

1. Brazing rods with a silver content of no less than 20% are recommended for copper-to-stainless steel welding, and brazing rods with a silver content of 5% for copper-to-copper welding. All components shall be installed firmly and neatly. Higher welding proficiency is required when using low-phosphorus brazing rods.
2. Anti-oxidation protection shall be adopted during welding. No slag or foreign impurities shall remain inside the pipeline system after welding, and all welding joints shall be smooth.
3. After assembly, fill the refrigerant system with nitrogen for pressure holding test at 3.2 MPa. The pressure gauge reading shall remain stable within 10 hours.
4. All low-temperature copper pipes and the evaporator surface shall be wrapped with thermal insulation cotton.
5. Thermal insulation treatment shall also be performed on temperature sensing probes.

33	YE90042402100	Bypass solenoid valve PMP-4A10	Assembly	2	
32	YE15200300400	Steel nut 1/4 inch - 20 P pipe transition (P)	Structural parts	2	
31	YM70012201600	Oil Lin Compressor ZP12X(C)-TD	Assembly	2	
30	SIC-76W-R2-C-05	Return air pipe 2	TP2M	1	
29	YW66061300000	Flat Washer Grade A GB/T97.18	14.0HV	20	
28	YW65008000100	Standard spring washer GB/T93.8	65Mn	20	
27	YW64080600000	Hexagon nut GB/T6170 M8	5.0	20	
26	YW60085000000	Hexagon head bolt GB/T5783 M6*0.8	4.8	8	
25	YS3095284.0000	Bypass valve outlet pipe	TP2M	0.5	
24	SIC-76W-R2-C-11	Filter outlet pipe 3	TP2M	1	
23	SIC-76W-R2-C-09	Condenser outlet pipe 2	TP2M	1	
22	SIC-76W-R2-C-10	Filter outlet pipe 2	TP2M	1	
21	YR60001100100	Pressure hose RC-01 (SHI)	Assembly	4M	
20	YW80716200100	Pressure sensor copper straight-through	Assembly	4	
19	YW80000100200	Straight-through SZT-41 (with diaphragm)	Assembly	4	
18	YS30063500000	Pressure equalizing pipe of expansion valve	TP2M	0.3	
17	YW87011406000	Flare expander GB/T97.14 (hale M10*0.5)	Assembly	1	
16	SIC-76W-R2-C-12	Expansion valve outlet pipe 2	TP2M	1	
15	YW85001500100	Hydroscope HMI-ITTS	Assembly	2	Option
14	YE15200500400	Steel nut 1/4 inch - 20 P pipe transition (P)	Structural parts	2	
13	YW59001400600	Copper T-shaped joint 1/4" TP2M	TP2	2	
12	YW85010400300	Liquid filling needle valve 1/4 inch (for R410A)	Assembly	6	
11	YS30063500000	Soft copper pipe $\phi 6.35 \times 0.6$	TP2M	0.5	
10	YW86762000100	Condenser SIC-76W-R2-C-02 Rev A	Assembly	2	
9	YE90207500500	Liquid pipe solenoid valve 20MM/15T	Assembly	2	Option
8	SIC-76W-R2-C-07	Filter outlet pipe 1	TP2M	1	
7	YW85016500100	Drying filter EK 16SS	Assembly	1	
6	SIC-76W-R2-C-06	Condenser outlet pipe 1	TP2M	1	
5	SIC-76W-R2-C-08	Expansion valve outlet pipe 1	TP2M	1	
4	YW51635000100	Wedge gate solenoid valve 1/4 inch (for R410A)	TP2M	2	
3	SIC-76W-R2-C-03	Exhaust pipe	TP2M	2	
2	SIC-76W-R2-C-04	Return air pipe 1	TP2M	1	
1	YW85712500000	Expansion Valve 5/8x1/8 ODF SVT	Assembly	1	

(E1)

序号	代号	名称	材质	数量	备注
		标题 SIC-76W-R2 冷媒系统	图号 SIC-76W-R2-C-ALL	比例 1:18	数量 1
				材质	组合件
(E1)	无	新增零件	20260515	表面要求	/
标记	更改前	更改后	更改人	日期	审核
				日期	20210625

SHINI 信易电热机械股份有限公司
Shini Plastics Technologies, Inc.

Cooling capacity/water outlet temp. T1(°C)	Cooling capacity/water outlet temp. T2(°C)	Cooling capacity/water outlet temp. T3(°C)	Total power (middle/high pressure)	Cooling water inlet(inch)	Cooling water outlet(inch)	Chilled water inlet (inch)	Chilled water outlet (inch)	Drainage outlet(inch)	Water tank refill port (inch)	Cooling water flow L/min	Flow rate of chilled water(L/min)	Water tank capacity(L)	Weight(kg)	Ver.
91kw	100kw	114kw	24.3/24.7kw	Rc2	Rc2	Rc2	Rc2	Rc1/2	Rc1/2	408.5	326.8	180	720	C

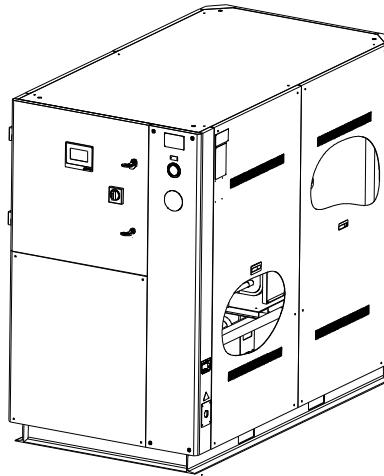
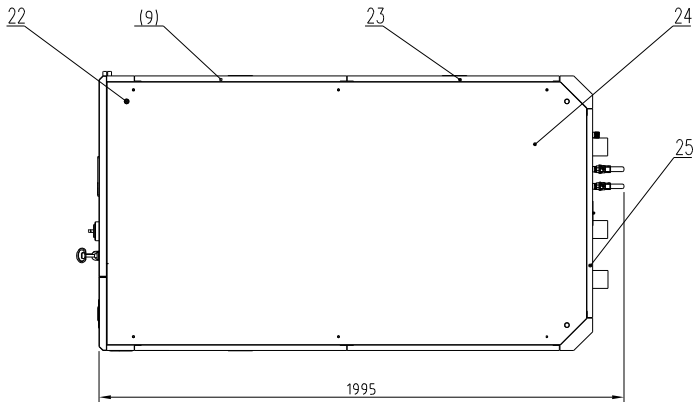
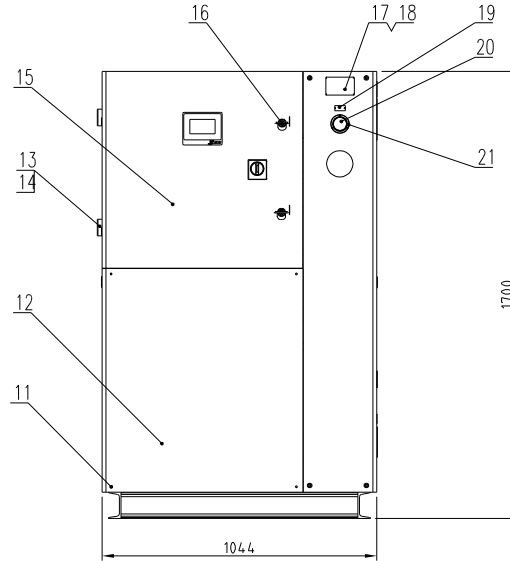
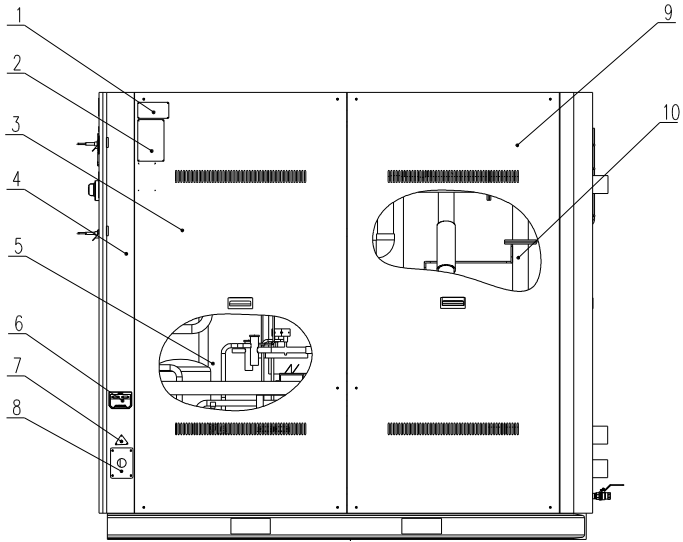

Technical Requirements
 1. Tighten all component fastening screws to specified torque to prevent loosening.
 2. No paint peeling or scratches on outer surfaces.
 3. Panels shall be easily assembled and disassembled without interference or binding.

25	SIC-114W-R2-ALL-05	Rear panel	SPCC15	1	
24	SIC-114W-R2-ALL-06	Top plate	SPCC15	1	
23	SIC-114W-R2-ALL-07	Side plate 3	SPCC15	1	
22	YW09001600000	Eye screw GB/T325 M16	Structural parts	4	
21	YP30425000000	Pump pressure gauge	Assembly	1	
20	YW63030600000	Cross recessed pan-head screw M6		4.8	3
19	YP30425000000	Pump Pressure Label		2024	1
18	YP30804900700	Nameplate of machine	Assembly		1
17	YW69020500000	Rivet 2 X 5		4.8	21
16	YW00816100000	Door lock	SPCC15		2
15	SIC-114W-R2-ALL-01	Front upper door panel	SPCC15		1
14	YW62051000100	Cross recessed big flat head screw M10 L8		4.8	12
13	YW062031004.00	Hinge large (L203-1 (left))	Structural parts		2
12	SIC-114W-R2-ALL-02	Front lower door panel	SPCC15		1
11	YW62063500000	Cross recessed big flat head screw M6.5		4.8	26
10	SIC-114W-R2-B-ALL	Water system	Assembly		1
9	SIC-114W-R2-ALL-03	Side plate 1	SPCC15		2
8	BL02010000020	Wire clamp fixing plate M2	SPCC15		1
7	YP31051650000	Delta power supply 3 φ 400V	Structural parts		1
6	YR40048500000	Housing RS485 Rev 0	Assembly		1
5	SIC-114W-R2-C-ALL	Refrigerant system	Assembly		1
4	SIC-114W-R2-A-ALL	Rack assembly	Assembly		1
3	SIC-114W-R2-ALL-04	Side plate 2	SPCC15		1
2	YP31018600000	Notes Label	Structural parts		1
1	YP311158004.00	Aluminum plate label for maintenance of chiller	Structural parts		1

序号	代号	名称	材质	数量	备注
		制图			
		设计			
		校对			
		审核			
		版号	1		
		标题	SIC-114W-R2		
		图号	SIC-114W-R2-ALL		
		比例	1:18		
		数量	1		
		表面要求			
		物料号			



⑪	更改前	更改后	更改人	日期	审核	日期	20210625
	见本图			20260511			

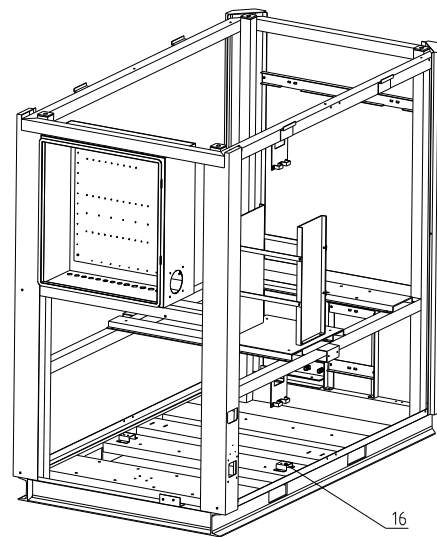
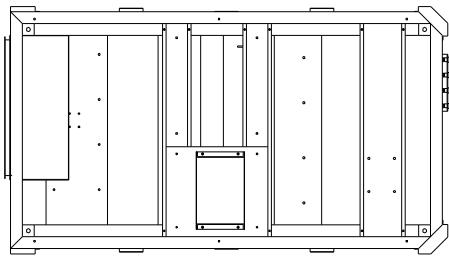
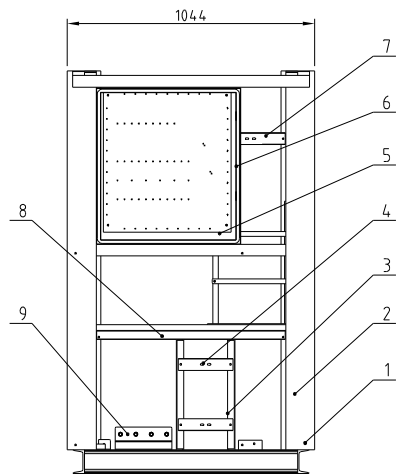
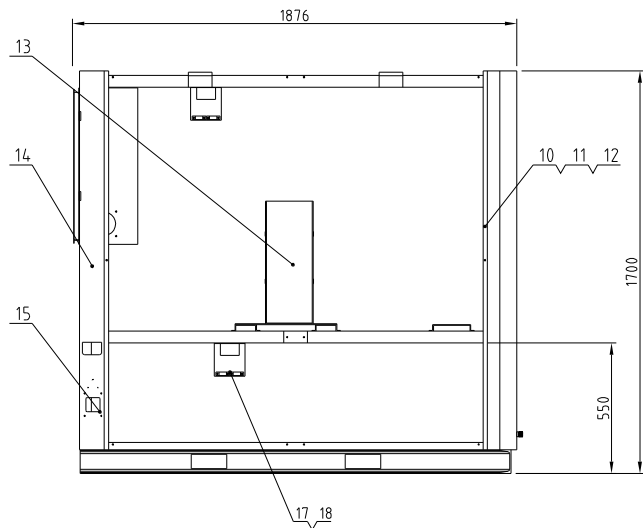

①	18	SIC-039	Sensor fixing plate	SPCC2.0	2	
	17	SIC-038	Sensor fixing clamp	SPCC15	4	
	16	SIC-114 W-R2-A-23	Supporting block	SPCC15	2	Option
	15	BL02010000020	Fixing plate of wire clamp	4.8	1	
	14	SIC-114 W-R2-ALL-01	Frame welding drawing	Assembly	1	
	13	SIC-114 W-R2-A-15	Evaporator fixed groove	SPCC3.0	2	
	12	YW66061300000	Flat Washers Class A 6	4.8	20	
	11	YW65006000100	Standard spring washer 6	4.8	20	
	10	YW60062000100	Hexagon bolt M6x20	4.8	20	
②	9	SIC-33A-R2-A-38	Drainage fixed plate combination	SPCC2.0	1	Borrowed
	8	SIC-114 W-R2-A-19	Rear middle crossbeam	SPCC2.0	1	
	7	SIC-114 W-R2-A-17	Fixing beam of water inlet and outlet pipe	SPCC3.0	1	
	6	SIC-114 W-R2-A-06	Electric cabinet	SPCC15	1	
	5	SIC-114 W-R2-A-04	Electrical base plate	SPCC15	1	
	4	SIC-114 W-R2-A-22	Condenser fixing plate	SPCC2.0	2	
	3	SIC-114 W-R2-A-20	Condenser fixing strip 1	SPCC3.0	2	
	2	SIC-114 W-R2-A-01	Surface plate	SPCC15	1	
	1	YW62063500000	Big flat head screw M6 * 35	4.8	4	
	序号	代号	名称	材质	数量	备注

Technical Requirements

- All component fastening screws shall be tightened to specified torque and free of looseness.
- No paint peeling or scratches on exterior surfaces.
- Panels shall be easy to assemble and disassemble without interference or jamming.

制图	版号	标题	图号	比例	数量	备注
设计	F	SIC-114 W-R2	SIC-114 W-R2-A-ALL	1:20	1	
校对	核准	机架组合		材质	组合件	
①	/	新增和取消钣金件		表面要求	/	
标记	更改前	更改后	更改人	物料号	/	
20260511	20210625					

SHINI 信易電熱機械股份有限公司
Shini Plastics Technologies, Inc.

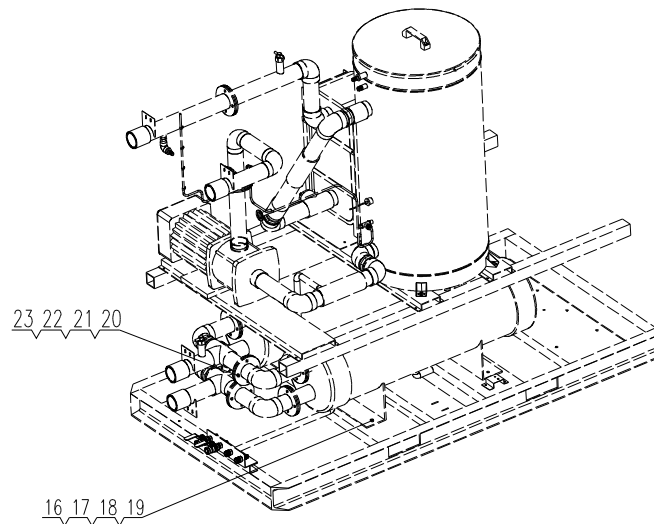
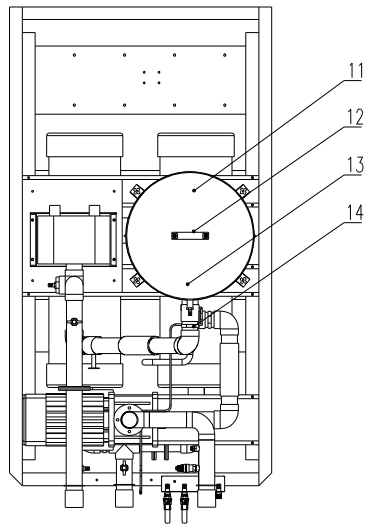
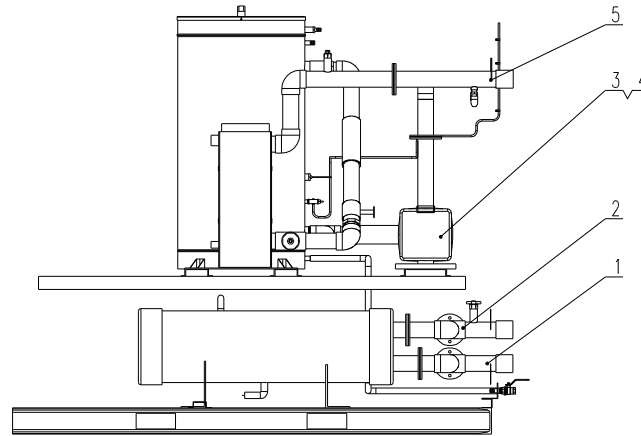
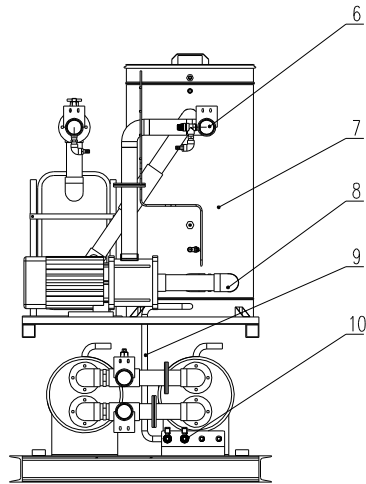

Technical Requirements
 1 All threaded joints shall be sealed with PTFE tape.
 2 Special adhesive shall be used for PVC-U pipe connections.
 3 No leakage is permitted under 0.7 MPa pressure.
 4 Do not fill with water within 24 hours after assembly.

23	YW66081600000	Flat Washer Grade A GB/T93.1 (4*16*1.6)	14.0HV	64	
22	YW65008000100	Standard spring washer GB/T93.8	65Mn	32	
21	YW60083000200	Hexagon bolt GB/T5783 M8*20-8.8	8.8	32	
20	YW64.080600000	Hexagon nut GB/T6170 M8	8	32	
18	YW60082500100	Hexagon bolt M8 * 25-12.9	4.8	8	
17	YW64.080600000	Hexagon nut GB/T6170 M8	5.0	8	
16	YW65006000100	Standard spring washer GB/T93.8	65Mn	8	
15	YW66061300000	Flat Washer Grade A GB/T93.1B	14.0HV	8	
14	SIC-114-W-R2-B-03	Combination of plate endange outlet pipe	Assembly	1	
13	YW59010200000	Float switch copper 1/2"	Assembly	1	
12	BW2001200004.0	Aluminum square handle head	Assembly	1	
11	SIC-33A-R2-B-08	Water tank cover	SUS201	1	Borrowed
10	YW50001208200	Copper ball valve (2 inch (nominal C thread)	Assembly	2	
9	YR60051000000	Inner diameter of steel wire hose 10MM * 1MM	Assembly	8M	
8	SIC-114-W-R2-B-04	Pump suction pipe assembly	Assembly	1	
7	SIC-114-W-R2-B-08	Water tank body	Assembly	1	
6	SIC-114-W-R2-B-05	Water pump outlet pipe combination	Assembly	1	
5	SIC-114-W-R2-B-02	Return pipe assembly	Assembly	1	
4	YM21204.0014.00	Nanyuan Water Pump SHP20-40	Assembly	1	High pressure use
3	YM21203.0010.00	Nanyuan Water Pump SHP20-30	Assembly	1	Medium pressure use
2	SIC-114-W-R2-B-07	Condenser water outlet pipe combination	Assembly	1	
1	SIC-114-W-R2-B-06	Condenser water inlet pipe assembly	Assembly	1	
序号	代号	名称	材质	数量	备注

版号	F	标题	SIC-114-W-R2	图号	SIC-114-W-R2-B-ALL	比例	1:18	数量	1
设计		水系统							
①	更改前	更改后	更改人	日期	审核	日期	20210625	表面要求	/
标记	更改前	更改后	更改人	日期	审核	日期	20210625	物料号	/

SHINI 信易电热机械股份有限公司
 Shini Plastics Technologies, Inc.

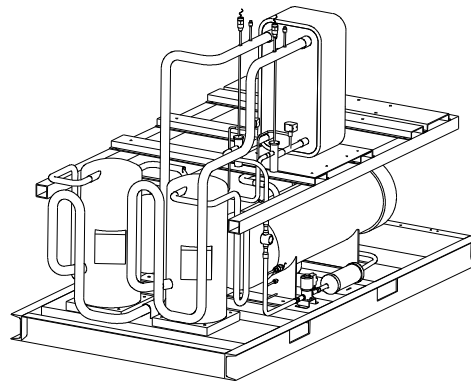
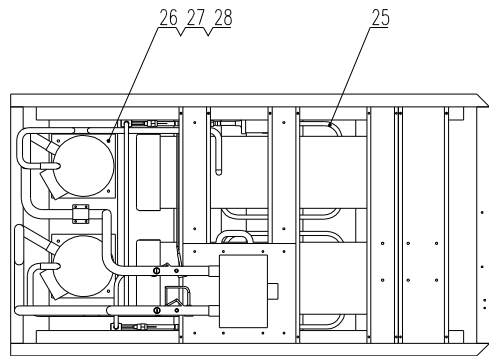
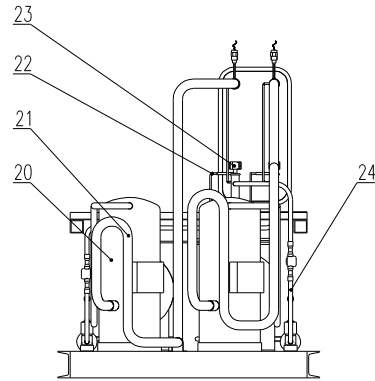
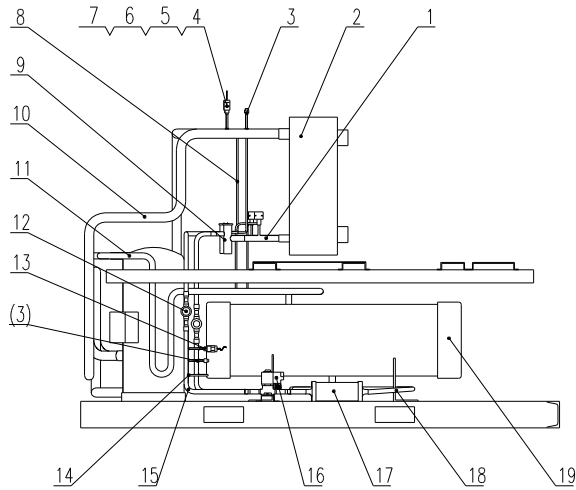

Technical Requirements

- 1 Silver brazing filler $\geq 20\%$ is recommended for copper-to-stainless steel joints, and 5% silver filler for copper-to-copper brazing. All parts shall be fixed firmly with neat appearance. Higher brazing skill is required when using low-phosphorus brazing rods.
- 2 Anti-oxidation shielding is required during brazing; no slag or foreign debris left inside piping after brazing, all brazed joints shall be smooth.
- 3 After assembly, pressurize refrigerant system with nitrogen at 3.2 MPa for holding test; pressure gauge reading keeps unchanged within 10 hours.
- 4 Wrap thermal insulation cotton on all low-temperature copper tubes and evaporator surface.
- 5 Apply thermal insulation for temperature probes as well.

28	YW66082200100	Large washer C grade C (R. 6.2x2)	14.0HV	8	
27	YW65008000100	Standard spring washer G/TP3 8	65Mn	8	
26	YW60085000000	Hexagon head bolt G/TP303 M6.0-8.8	4.8	8	
25	SIC-114 W-R2-C-10	Condenser outlet pipe 2	TP2M	1	
24	SIC-114 W-R2-C-11	Filter outlet pipe 2	TP2M	1	
23	YE900624.02100	Bypass solenoid valve FHF-6M2	Assembly	2	
22	YS3095284.00000	Bypass valve outlet pipe	TP2M	0.5	
21	SIC-114 W-R2-C-08	Return air pipe 2	TP2M	1	
20	YM70018200000	Oil Lan Compressor ZPIE30CB-TFD	Assembly	2	
19	BW860114.00010	Condenser SIC-114W-R2-C-02 Rev A	Assembly	2	
18	SIC-114 W-R2-C-05	Condenser outlet pipe 1	TP2M	1	
17	YW85030500100	Drying filter EK30FS	Assembly	2	
16	YE90207500500	Liquid pipe solenoid valve 200075T	Assembly	2	Option
15	SIC-114 W-R2-C-06	Filter outlet pipe 1	TP2M	1	
14	YS30063500000	Soft copper pipe $\phi 6.35 \times 0.6$	TP2M	0.5	
13	YE152005004.00	Head nut 1/8 in. -20 # brass hexamer (1/8)	Structural parts	2	
12	YW85001500100	Hydroscope FMI-1TT5	Assembly	2	Option
11	SIC-114 W-R2-C-04	Exhaust pipe 1	TP2M	1	
10	SIC-114 W-R2-C-03	Return air pipe 1	TP2M	1	
9	YW85165800000	Expansion valve TBS 16-2M 5/8 * 7/8	Assembly	1	
8	YS30063500000	Pressure equalizing pipe of expansion valve	TP2M	0.5	
7	YR60001100100	Pressure hose RG-01 (SHI)	Assembly	4M	
6	YW80716200100	Pressure sensor copper straight-through	Assembly	4	
5	YW80000100200	Straight-through SZF-4L (with diaphragm)	Assembly	4	
4	YE152003004.00	Head nut 1/8 in. -20 # brass hexamer (1/8)	Structural parts	2	
3	YW850104.00300	Liquid filling needle 1/4 inch (for R410A)	Assembly	10	
2	YW87660900000	Plate evaporator SIC-114W-R2-C-01-0	Assembly	1	
1	SIC-114 W-R2-C-07	Evaporator liquid inlet pipe 1	TP2M	1	

(C1)
(C1)
(C1)

序号	代号	名称	材质	数量	备注
		制图	版号	C	标题 SIC-114 W-R2
		设计	核准		图号 SIC-114 W-R2-C-ALL
		校对	日期	20210625	比例 1:18
		审核	日期	20210625	数量 1
(C1)	无	新增零件	20260515	校核	材质 组合件
标记	更改前	更改后	更改人	日期	表面要求 /
					物料号 /

SHINI 信易电热机械股份有限公司
Shini Plastics Technologies, Inc.